

Sister Wimberly Playground – Swan Lake

ITB #12 – 25/26

Addendum #2 – October 30, 2025

The following clarifications or additions shall become part of the contract documents and shall be included in the lump sum contract price for the project:

1. The contractor shall attend weekly coordination meetings with the City of Sumter project manager and the landscape architect on the project site.
2. Refer to the attached revised page of the bid documents. The time to substantial completion shall be 210 days.
3. Refer to the attached playground installation Gantt chart timeline. Playground equipment installation is to be completed by a previously selected playground installer. After award of contract, the contractor and playground installer shall coordinate sequencing and scheduling and the contractor shall prepare a written schedule for the project including playground installation elements.
4. The contractor is responsible for the removal and disposal of all of the existing play equipment.
5. The fire truck will be removed prior to construction by the City of Sumter and re-positioned at the completion of the project by the City of Sumter.
6. Refer to the revised sheet L1.0 and revised tree protection and removal legend and notes on that sheet for additional information on trees to have stumps removed and trees to have stumps ground.
7. Refer to revised sheets L2.1, L2.2 and L4.2 for extended concrete drive along the east edge of the project area and for additional information about heavy duty concrete pavement in that area. The modified area is between the restroom building and the existing utility building to the east and extends approximately from the parking area south to the revised and extended end of the concrete drive.
8. Refer to revised sheet L2.4 for additional drainage structure details.
9. The city reserves the right to conduct field compaction and concrete strength testing. The contractor should not include such testing in their bid price.

10. A hand hole is not required at the current location of Panel C which is to be relocated to the back of the restroom building. Refer to Note 1 on sheet E4.0. The contractor shall extend the conduits back to Panel-D and re-pull the wire to the first device that it hits. If the contractor would like to install a hand hole, use Quazite Model PG17X30H00 with a flush cover.
11. The contractor shall secure the lay down area with approximately 140 linear feet of temporary 6 foot tall chain link fencing including a gate with a lock. The laydown area shall be locked during non-working hours. The contractor shall coordinate the layout of the fencing with the landscape architect and City of Sumter project manager in order to protect existing trees in the area and to maintain access for park staff along the access drive to all other areas of the park. The contractor shall also install approximately 250 linear feet of tree protection fencing on the west and north sides of the lay down area. The resulting space will yield an approximately 9000 square foot lay down area which is to be shared with the playground equipment installer. Prior to using the lay down area, the contractor shall stake existing irrigation structures with wood stakes to protect them from damage during construction. At project completion the contractor shall fine grade disturbed areas to remove ruts and shall seed the disturbed space with centipede seed according to the seeding sections of the Planting specifications in the project manual. The contractor shall return the irrigation system to its original working order.
12. Stone from existing demolished work shall be cleaned and reused for the construction of new stone pillars. The contractor shall break stones to sizes suitable for the new pillars as detailed on sheet L6.3.
13. Refer to revised details 4 and 5 on sheet L6.1 and detail 2 on sheet L6.4 which clarify that stone below finished playground surfacing is to be installed by the playground installer after excavation and drainage installation by the contractor. Drainage installation by the contractor shall include #57 stone, pipe and geotextile fabric as detailed. Any items not labeled as “BY PLAYGROUND INSTALLER” or “BY OTHERS” shall be installed by the contractor.
14. Refer to revised sheet L7.1 for limits of mulch within existing wooded areas.
15. Refer to revised sheet L7.1 for additional notes regarding the existing irrigation system.
16. Liton part IG14UE-T30 **is not** an approved substitution for item D on the lighting fixture schedule.

Receipt of this addendum must be acknowledged on the bid form.



CITY OF SUMTER BID FORM

City of Sumter, South Carolina, a Body Politic and Corporate and Political Subdivision of the State of SC

FORMAL INVITATION-TO-BID: ITB #12-25/26

Sister Wimberly Playground - Swan Lake

BID MUST BE RECEIVED BY: Tuesday, November 4, 2025 at 2:00pm ET at below address.

MANDATORY PRE-BID MEETING ON: Tuesday, October 21, 2025 at 10:00 AM

MAIL, OVERNIGHT OR HAND CARRY TO:

City of Sumter Department of Public Works

Attn: Procurement Department

303 East Liberty Street

Sumter, SC 29150

ITB #12 – 25/26:

Hardscape and landscape improvements to the playground area and parking including asphalt paving, brick walkways, concrete walkways, subsurface preparation and drainage, erosion control, concrete edging, concrete curb and gutter, brick walls and columns, stone columns, steel work gateway and signage, steel fencing accent pieces, planting and irrigation.

*PRICING WILL REMAIN VALID FOR 90 DAYS AFTER BID CLOSING DATE.

*COI's MAY BE EMAILED TO (tbutts@sumtersc.gov).

Base Bid: Single-Prime (All Trades) Contract: The undersigned Bidder, having carefully examined the Procurement and Contracting Requirements, Conditions of the Contract, Drawings, Specifications, and all subsequent Addenda, as prepared by McIver Landscape Architecture and Architect's consultants, having visited the site, and being familiar with all conditions and requirements of the Work, hereby agrees to furnish all material, labor, equipment and services necessary to complete the construction of the above-named Project, in accordance with the requirements of the Procurement and Contracting Documents, for the stipulated sum of:

_____ Dollars (\$_____).

Time of Completion: The undersigned Bidder proposes and agrees hereby to commence the Work of the Contract Documents on a date specified in a written Notice to Proceed to be issued by Architect, and to substantially complete the Work within **two hundred and ten (210) calendar days.**

Acknowledgement of Addenda: The undersigned Bidder acknowledges receipt of and use of the following Addenda (if applicable) in the preparation of this Bid:

1. Addendum No. 1 _____ (date of addendum and bidder initials)
2. Addendum No. 2 _____ (date of addendum and bidder initials)
3. Addendum No. 3 _____ (date of addendum and bidder initials)
4. Addendum No. 4 _____ (date of addendum and bidder initials)

Playground Project Gantt Chart (Final)

Task	Start	End	Duration	Notes
Order Placement	Day 1, Week 1	Day 1, Week 1	1 day	Finalize order and confirm lead times
Shipping / Manufacturing	Week 1	Week 12	12 weeks	Includes production and delivery to site
Site Preparation	Week 11	Week 11	1 week	General site prep prior to installation
Large Equipment Installation	Week 12	Week 13	2 weeks	Install primary structures (climbers, swings, etc.)
Remaining Equipment Installation	Week 14	Week 16	3 weeks	Install smaller components and hardware
Surfacing Installation (PIP, Turf, etc.)	Week 17	Week 19	3 weeks	Final surfacing, compaction, and inspection

WALTER JAMES CARR, III, ETAL
 TM# 228-16-02-021
 DB, 1313 PG. 695
 LOT No. 13
 PB, Z-9 PG. 118

MATHEW R. MACK
 TM# 228-16-02-020
 DB, 1161 PG. 3237
 LOT No. 12
 PB, Z-9 PG. 118

JOSEPH MICHAEL LAUTATO &
 VICKI B. LAUTATO
 TM# 228-16-02-019
 DB, 1067 PG. 1499
 LOT No. 11
 PB, Z-9 PG. 118

PATRICIA C. MCGRAW, LE
 TM# 228-16-02-018
 DB, 1311 PG. 2108
 LOT No. 10
 PB, Z-9 PG. 118



SEPT 29, 2025

REV. DATE	NAME
10-30-2025	ADDENDUM #2

TREE PROTECTION AND REMOVAL PLAN

L1.0



0' 10' 20'
SCALE 1" = 20'-0"

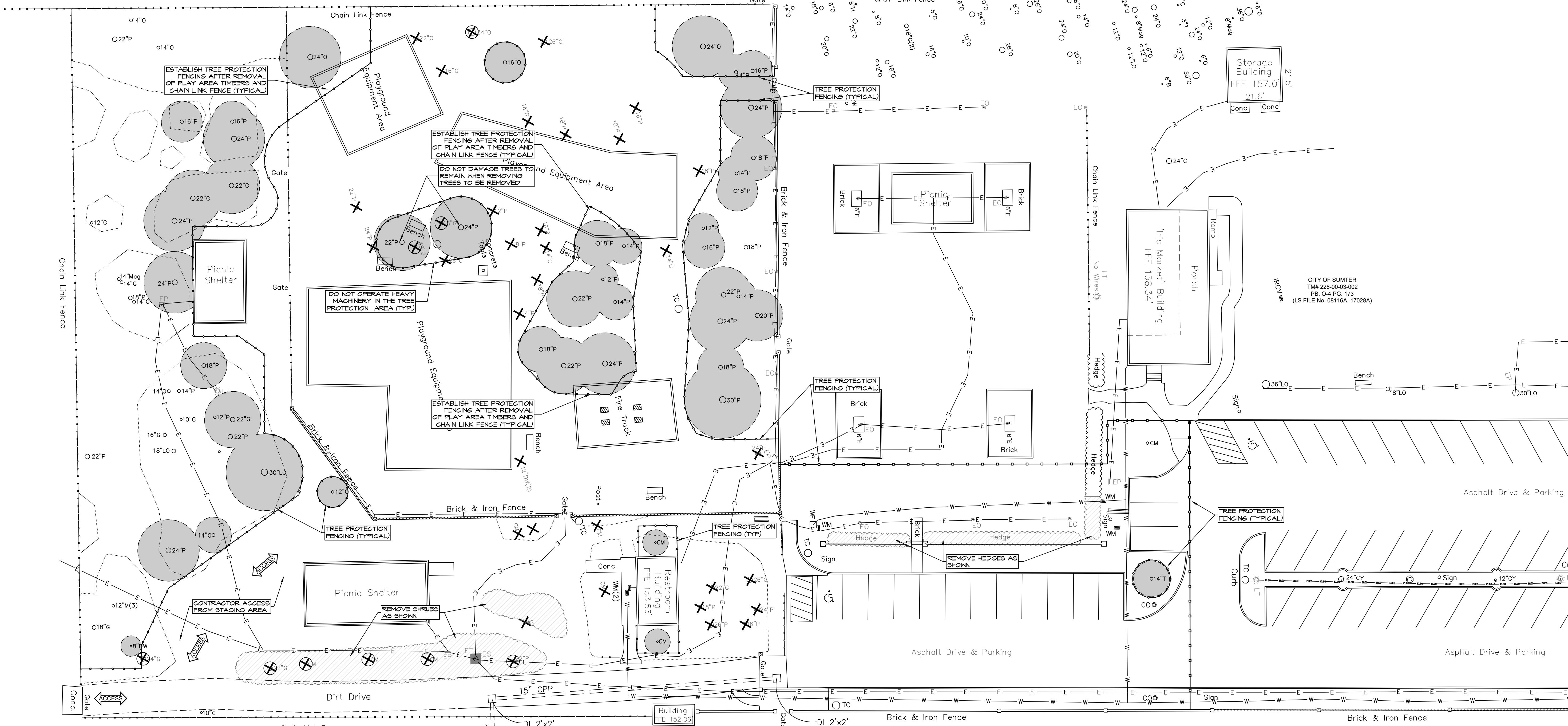

1 TREE PROTECTION AND REMOVAL PLAN
 SCALE: 1" = 20' - 0"

TREE PROTECTION FENCING NOTES

- THE TREE PROTECTION DEVICE SHALL BE A 4' TEMPORARY ORANGE SAFETY FENCE SIMILAR TO TENAX BEACON PLUS SAFETY FENCE AND SHALL BE INSTALLED AROUND THE PERIMETER OF THE TREE PROTECTION ZONE. THE FENCE SHALL BE ATTACHED TO METAL POSTS SPACED NO FARTHER THAN 8' ON CENTER.
- IF THE TREE PROTECTION BARRIER IS PLACED WITHIN THE DRIP LINE, A QUALIFIED ARBORIST SHALL BE CONSULTED PRIOR TO PERFORMING THE WORK.
- AN ARBORIST SHALL BE CONSULTED PRIOR TO CUTTING ANY ROOTS. WRITTEN DOCUMENTATION SHALL BE KEPT REGARDING THE ARBORIST'S RECOMMENDATIONS AND THE ACTIONS TAKEN.
- TREE PROTECTION DEVICES SHALL BE ERECTED PRIOR TO THE START OF CONSTRUCTION AND SHALL REMAIN IN PLACE UNTIL ALL SITE WORK IS COMPLETED AND LANDSCAPE INSTALLATION HAS BEGUN.
- BROKEN OR DISLODGED TREE PROTECTION DEVICES SHALL BE IMMEDIATELY REPAIRED.
- ALL DESIGNATED TREE PROTECTION ZONES MUST BE PROTECTED FROM THE SEDIMENTATION AND EROSION.
- SILT FENCING SHALL BE PLACED ALONG THE OUTER UPHILL EDGE OF TREE PROTECTION ZONES AT THE LAND DISTURBANCE INTERFACE.
- NO VEHICLES SHALL BE PARKED, OR CONSTRUCTION MATERIAL STORED OR SUBSTANCES PAURED OR DISPOSED OF OR PLACED, WITHIN ANY TREE PROTECTION ZONE AT ANY TIME DURING CLEARING OR CONSTRUCTION OF THE PROJECT.
- NO CHANGE IN GRADE WITHIN THE TREE PROTECTION ZONE SHALL BE ALLOWED AROUND EXISTING TREES EXCEPT FOR A MAXIMUM ADDITIONAL OF TWO INCHES OF MULCH UNLESS APPROVED BY THE OWNER.
- TREES WITHIN A TREE PROTECTION ZONE SHALL NOT BE PRUNED OR REMOVED WITHOUT PRIOR KNOWLEDGE AND WRITTEN CONSENT FROM THE OWNER.
- ALL RETAINED OR PLANTED TREES SHALL BE PROTECTED OR SITUATED SO AS TO PREVENT DAMAGE FROM ENVIRONMENTAL CHANGES OR LAND DISTURBANCE RESULTING FROM ANY BUILDING OR FACILITY CONSTRUCTION WITHIN OR IMMEDIATELY ADJACENT TO THE CRITICAL ROOT ZONE OF THE TREE(S).
- ANY DAMAGE OR INJURY TO TREES SHALL BE REPORTED IMMEDIATELY TO THE OWNER.

TREE PROTECTION AND REMOVAL LEGEND AND NOTES:

- TREE TO BE REMOVED PER NOTE 4 BELOW
- TREE TO BE REMOVED PER NOTE 5 BELOW
- TREE TO REMAIN
- SHRUB TO BE REMOVED
- TREE PROTECTION FENCING

- THE CONTRACTOR SHALL CLEARLY MARK ALL TREES TO BE REMOVED AND OBTAIN WRITTEN APPROVAL FROM THE LANDSCAPE ARCHITECT AND THE CITY OF SUMTER PROJECT MANAGER PRIOR TO REMOVAL.
- TREES WHICH ARE TO HAVE STUMPS REMOVED SHALL BE MARKED WITH A DIFFERENT COLOR THAN THOSE WHICH ARE TO HAVE STUMPS GROUND.
- PLACE TREE PROTECTION FENCING AS SHOWN. MINIMUM DISTANCE FROM ANY TREE-TO-REMAIN IS ONE FOOT DIAMETER FOR EVERY INCH OF TREE DIAMETER AT BREAST HEIGHT.
- TREE STUMPS UNDER AND WITHIN 5' HORIZONTAL OF PROPOSED PAVEMENTS, SURACING, OR STRUCTURES SHALL BE COMPLETELY REMOVED, INCLUDING ROOTS LARGER THAN ONE INCH IN DIAMETER.
- TREE STUMPS IN NATURAL AREAS AND IN WOODCHIP AREAS AND WHERE NOTED SHALL BE GROUND TO 8 INCHES BELOW GRADE.
- SEE FILL NOTES FOR REQUIREMENTS TO FILL VOIDS (IE FROM REMOVED STUMPS).

GENERAL NOTES

- CONTRACTOR SHALL OBTAIN ALL NECESSARY PERMITS.
- THE CONTRACTOR IS HEREBY INFORMED OF THE EXISTENCE OF UNDERGROUND UTILITIES. THE CONTRACTOR SHALL BE RESPONSIBLE FOR THE EXACT LOCATION OF ALL UTILITIES, AND ANY AND ALL DAMAGE RESULTING FROM THE FAILURE TO DO SO. CONTACT PALMETTO UTILITY PROTECTION SERVICE AT 1-888/712-1871 AT LEAST 12 HOURS PRIOR TO COMMENCING CONSTRUCTION. UTILITY LOCATION INFORMATION MAY ALSO BE OBTAINED FROM LOCAL MUNICIPALITIES.
- CONTRACTOR SHALL INFORM LANDSCAPE ARCHITECT IF PROPOSED DESIGN IS IN CONFLICT WITH EXISTING OR PROPOSED UTILITIES. CONTRACTOR SHALL COORDINATE WITH LANDSCAPE ARCHITECT PRIOR TO CONSTRUCTION TO ADJUST PROPOSED DESIGN OR UTILITIES AS NECESSARY TO RESOLVE CONFLICTS.
- ACTUAL EXISTING CONDITIONS MAY REQUIRE ADJUSTMENT OF THESE PLANS TO FIT THE SITE. STAKE-OUT/LAYOUT OF DESIGN BY THE CONTRACTOR AND APPROVAL BY THE LANDSCAPE ARCHITECT IS REQUIRED PRIOR TO CONSTRUCTION.
- BASE PLAN DATA DERIVED FROM SITE SURVEY AS PREPARED BY LINDLER SURVEYING FOR THE CITY OF SUMTER, JANUARY 15, 2024 AND REVISED AUGUST 15, 2024.
- ALL ELEMENTS SHALL BE CONSTRUCTED ACCORDING TO APPLICABLE BUILDING CODES AND ACCORDING TO MANUFACTURER'S SPECIFICATIONS.
- REFER TO SPECIFICATIONS FOR ADDITIONAL INFORMATION AND REQUIREMENTS.

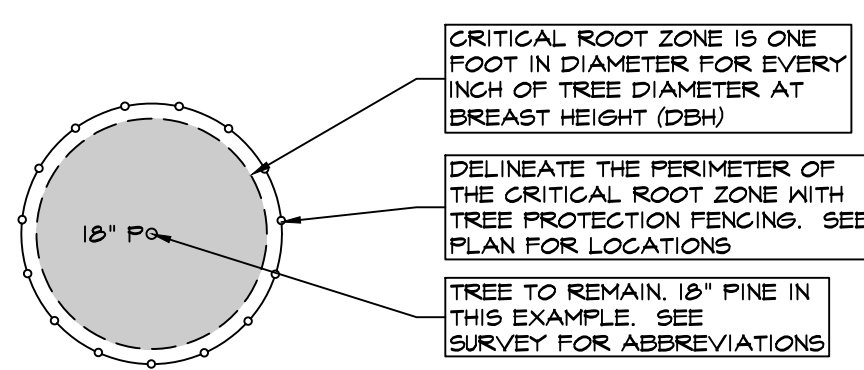

2 CRITICAL ROOT ZONE
 No Scale

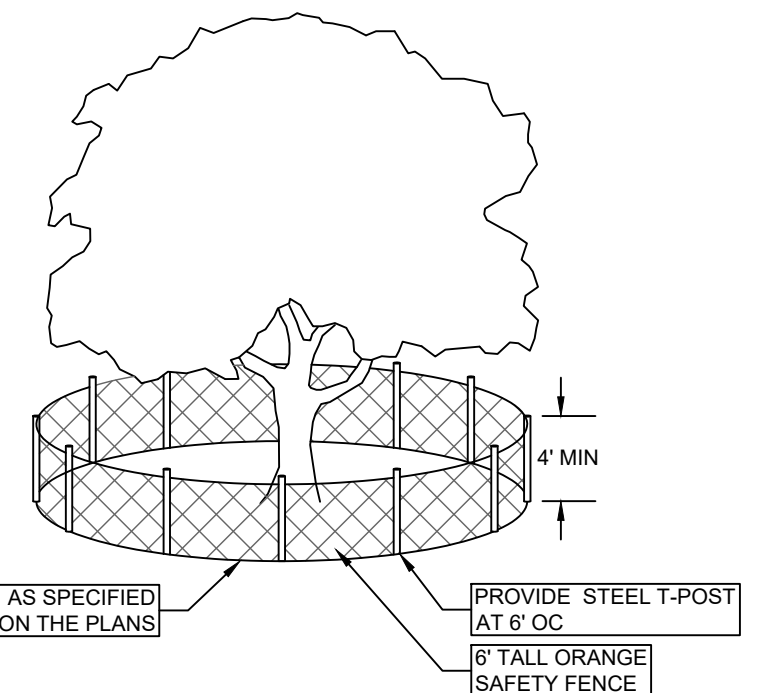

3 TREE PROTECTION FENCE
 No Scale

WALTER JAMES CARR, III, ETAL
 TM# 228-16-02-021
 DB, 1313 PG. 665
 LOT No. 13
 PB, Z-9 PG. 118

MATHEW R. MACK
 TM# 228-16-02-020
 DB, 1161 PG. 3237
 LOT No. 12
 PB, Z-9 PG. 118

JOSEPH MICHAEL LAUTATO &
 VICKI B. LAUTATO
 TM# 228-16-02-019
 DB, 1067 PG. 1499
 LOT No. 11
 PB, Z-9 PG. 118

PATRICIA C. MCGRAW, LE
 TM# 228-16-02-018
 DB, 1311 PG. 2108
 LOT No. 10
 PB, Z-9 PG. 118

GENERAL NOTES

- CONTRACTOR SHALL OBTAIN ALL NECESSARY PERMITS.
- THE CONTRACTOR IS HEREBY INFORMED OF THE EXISTENCE OF UNDERGROUND UTILITIES. THE CONTRACTOR SHALL BE RESPONSIBLE FOR THE EXACT LOCATION OF ALL UTILITIES, AND ANY AND ALL DAMAGE RESULTING FROM THE FAILURE TO DO SO. CONTACT PALMETTO UTILITY PROTECTION SERVICE AT 1-888-731-8877 AT LEAST 12 HOURS PRIOR TO COMMENCING CONSTRUCTION. UTILITY LOCATION INFORMATION MAY ALSO BE OBTAINED FROM LOCAL MUNICIPALITIES.
- CONTRACTOR SHALL INFORM LANDSCAPE ARCHITECT IF PROPOSED DESIGN IS IN CONFLICT WITH EXISTING OR PROPOSED UTILITIES. CONTRACTOR SHALL COORDINATE WITH LANDSCAPE ARCHITECT PRIOR TO CONSTRUCTION TO ADJUST PROPOSED DESIGN OR UTILITIES AS NECESSARY TO RESOLVE CONFLICTS.
- ACTUAL EXISTING CONDITIONS MAY REQUIRE ADJUSTMENT OF THESE PLANS TO FIT THE SITE. STAKE-OUT/LAYOUT OF DESIGN BY THE CONTRACTOR AND ADJUSTMENT/APPROVAL BY THE LANDSCAPE ARCHITECT IS REQUIRED PRIOR TO CONSTRUCTION.
- BASE PLAN DATA DERIVED FROM SITE SURVEY AS PREPARED BY LINDLER SURVEYING FOR THE CITY OF SUMTER, JANUARY 15, 2024 AND REVISED AUGUST 15, 2024.
- ALL ELEMENTS SHALL BE CONSTRUCTED ACCORDING TO APPLICABLE BUILDING CODES AND ACCORDING TO MANUFACTURER'S SPECIFICATIONS.
- REFER TO SPECIFICATIONS FOR ADDITIONAL INFORMATION AND REQUIREMENTS.

CITY OF SUMTER
 TM# 228-00-03-002
 PB, O-4 PG. 173
 (LS FILE No. 08116A, 17028A)

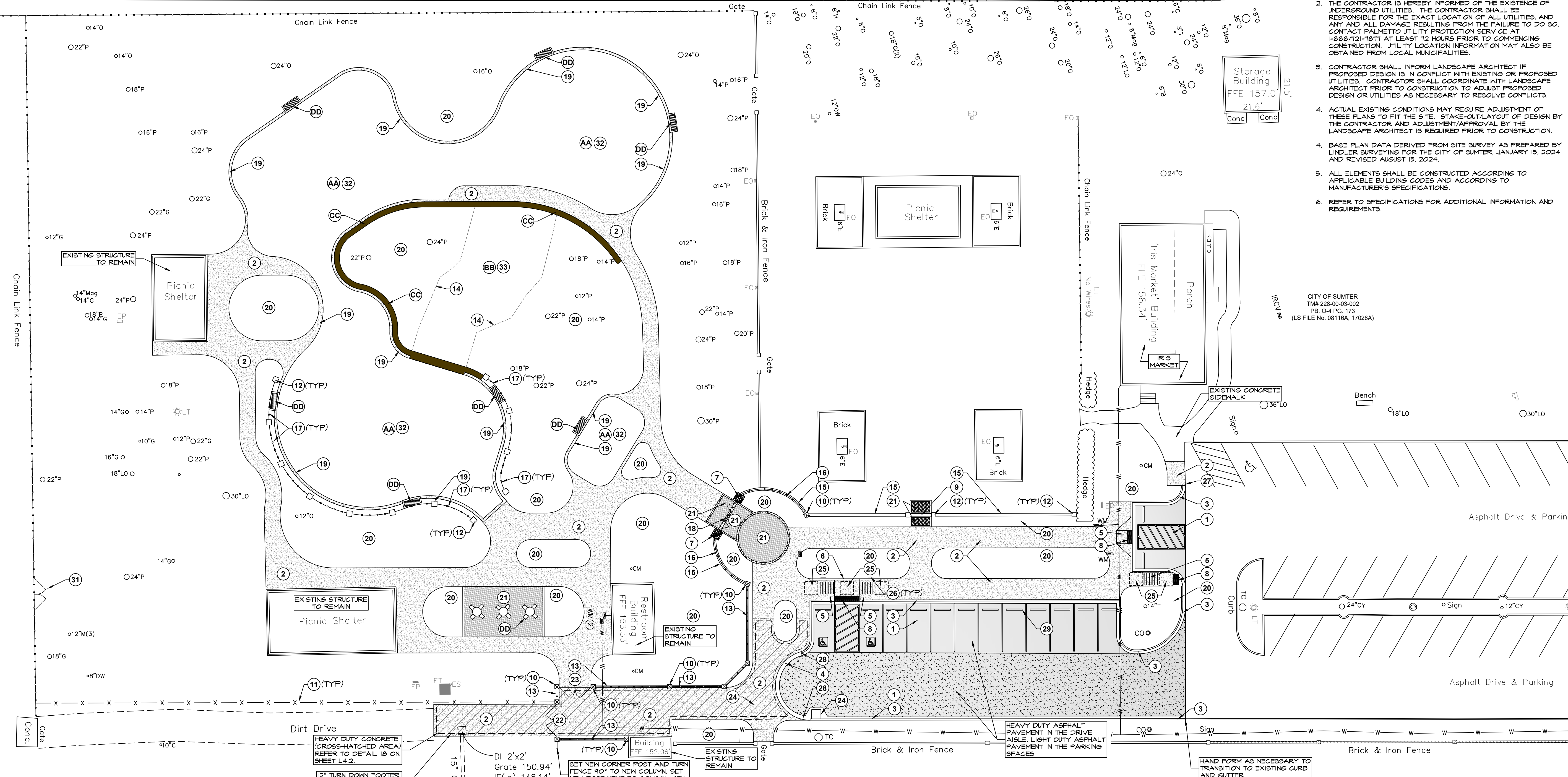

PROPOSED SITE FEATURES KEY

KEY	ITEM	DETAIL REFERENCE	NOTES
1	NEW ASPHALT PAVING AND PARKING STRIPING	REFER TO SITE DETAIL SHEETS L6.1-L6.4	
2	CONCRETE WALK WITH TOOLED SCORING	REFER TO SITE DETAIL SHEETS L6.1-L6.4	
3	CONCRETE CURB AND GUTTER	SEE L4.1	
4	CONCRETE ROLL CURB	SEE L4.1	
5	RAMPED CONCRETE SURFACE	SEE L4.1	
6	CONCRETE PLANTER CURB	REFER TO SITE DETAIL SHEETS L6.1-L6.4	
7	STONE COLUMNS FOR ENTRANCE GATE	REFER TO SITE DETAIL SHEETS L6.1-L6.4	
8	DETECTABLE WARNING SURFACE - BRICK PAVERS	REFER TO SITE DETAIL SHEETS L6.1-L6.4	
9	BRICK STEPS AND HANDRAILS	REFER TO SITE DETAIL SHEETS L6.1-L6.4	
10	MAJOR BRICK COLUMN	REFER TO SITE DETAIL SHEETS L6.1-L6.4	
11	6' TALL VINYL (BLACK) CHAIN LINK FENCE WITH TOP BAR	195 LF	
12	MINOR BRICK COLUMN	REFER TO SITE DETAIL SHEETS L6.1-L6.4	
13	8" BRICK WALL WITH IRON FENCING	REFER TO SITE DETAIL SHEETS L6.1-L6.4	
14	ROOT BARRIER		

KEY	ITEM	DETAIL REFERENCE	NOTES
15	12" WIDE BRICK WALL	REFER TO SITE DETAIL SHEETS L6.1-L6.4	
16	IRON FENCE MOUNTED ON BRICK WALL	REFER TO SITE DETAIL SHEETS L6.1-L6.4	
17	SHORT IRON FENCE	REFER TO SITE DETAIL SHEETS L6.1-L6.4	
18	ENTRANCE GATE	REFER TO SITE DETAIL SHEETS L6.1-L6.4	
19	CONCRETE BORDER/EDGE	REFER TO SITE DETAIL SHEETS L6.1-L6.4	
20	PLANTING AREA	SEE PLANTING PLAN	
21	BRICK PAVERS WITH CONCRETE EDGING	REFER TO SITE DETAIL SHEETS L6.1-L6.4	
22	RELOCATED IRON GATE		
23	VEHICULAR GATE	REFER TO SITE DETAIL SHEETS L6.1-L6.4	
24	NEW STORM DRAINAGE COMPONENTS	SEE L4.1	
25	ADA LANDING PAD	SEE L4.1	
26	HANDICAP SIGNAGE	SEE L4.1	TYPICAL 2 PLACES.
27	3' CURB TAPER	SEE L4.1	
28	HAND FORM TRANSITION FROM STD. CURB TO ROLL CURB. PROVIDE A 5' TRANSITION THAT IS SMOOTH AND GRADUAL.		

KEY	ITEM	DETAIL REFERENCE
29	PRECAST CONCRETE WHEELSTOP (TYPICAL 14)	
30	8"x3"x4"± CONCRETE SLAB	
31	RELOCATED CHAIN LINK GATE - FIELD VERIFY LOCATION WITH OWNER	
32	PREPARE SUBGRADE AND INSTALL STONE BASE. SURFACE BY OTHERS	REFER TO SITE DETAIL SHEETS L6.1-L6.4
33	PREPARE SUBGRADE, ENGINEERED WOOD FIBER SURFACE BY OTHERS	REFER TO SITE DETAIL SHEETS L6.1-L6.4

PROPOSED SITE ITEMS BY OTHERS

AA	PLAYGROUND SURFACING (BY OTHERS)
BB	ENGINEERED WOOD FIBER SURFACING (BY OTHERS)
CC	RUBBERIZED MULCH TRANSITION ZONE (BY OTHERS)
DD	SITE FURNITURE PROVIDED BY OTHERS, INSTALLED BY GC



822 West Liberty Street
 Sumter, SC

Sister Wimberly Playground



Jones and VanPatten, LLC
 Civil Engineers
 PO Box 567
 232 West Calhoun Street
 Sumter, SC 29151
 Phone: (803) 774-2127
 Fax: (803) 775-8747

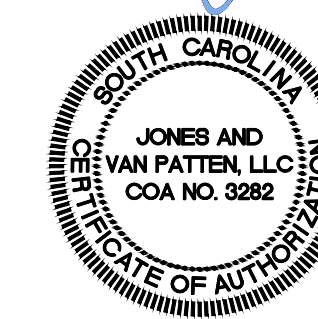
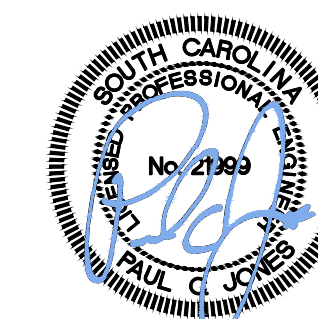

7 1/2 S. MAIN ST SUMTER, SC 29150
 803-968-3992 INFO@MCIVERLA.COM

SEPT. 29, 2025

REV. DATE	NAME
10-30-2025	ADDENDUM #2

SITE PLAN

L2.1



0' 10' 20'
 SCALE 1" = 20'-0"

WALTER JAMES CARR, III, ETAL
 TM# 228-16-02-021
 DB, 1313 PG. 665
 LOT No. 13
 PB, Z-9 PG. 118

MATHEW R. MACK
 TM# 228-16-02-020
 DB, 1161 PG. 3237
 LOT No. 12
 PB, Z-9 PG. 118

JOSEPH MICHAEL LAUTATO &
 VICKI B. LAUTATO
 TM# 228-16-02-019
 DB, 1067 PG. 1499
 LOT No. 11
 PB, Z-9 PG. 118

PATRICIA C. MCGRAW, LE
 TM# 228-16-02-018
 DB, 1311 PG. 2108
 LOT No. 10
 PB, Z-9 PG. 118

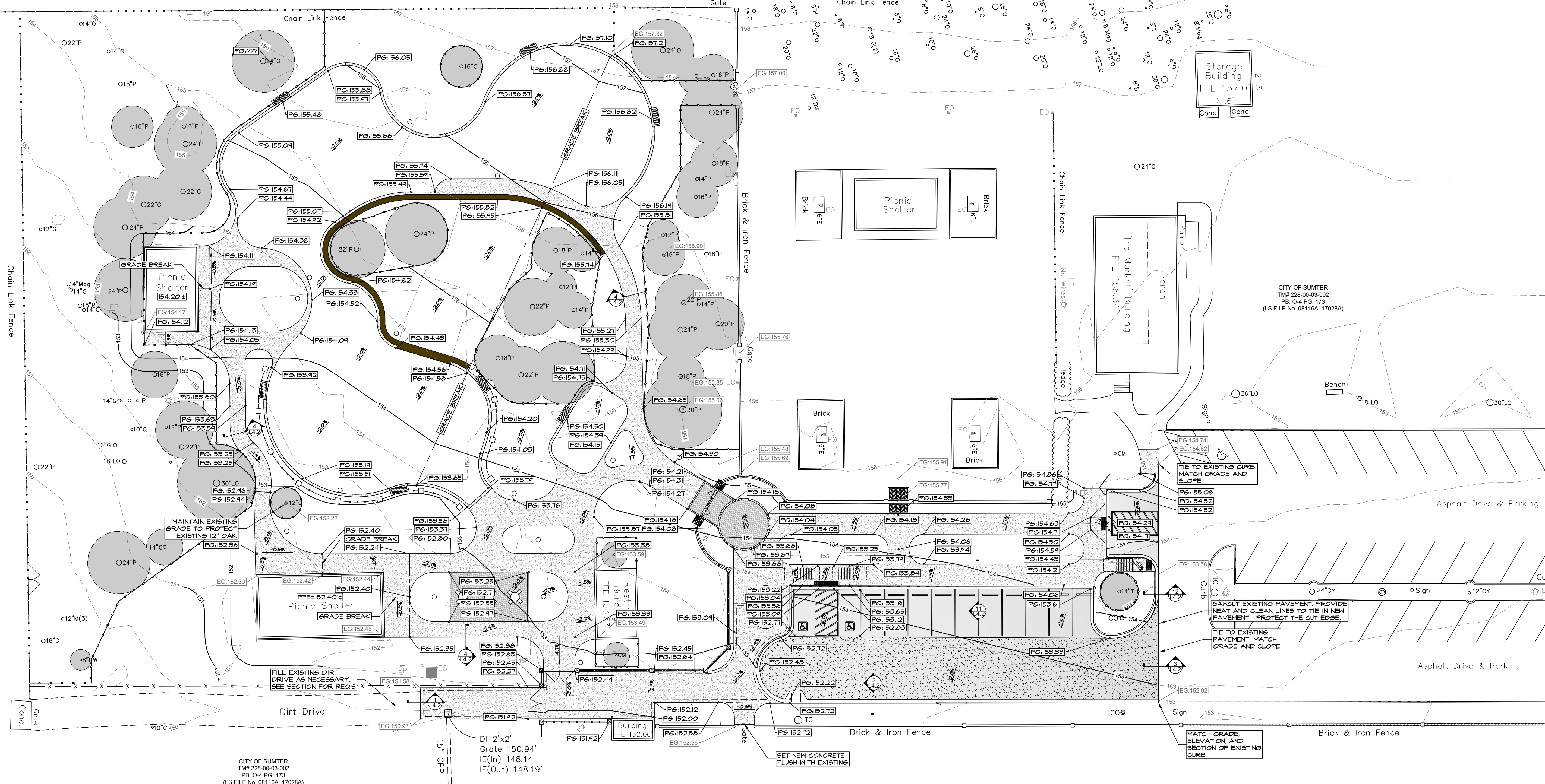

CITY OF SUMTER
 TM# 228-00-03-002
 PB, O-4 PG. 173
 (LS FILE No. 08116A, 17028A)

1 GRADING PLAN SCALE: 1" = 20' - 0"

GRADING NOTES

1. CONSTRUCT ALL NEW PAVED SURFACES WITH A MAXIMUM 5% SLOPE IN THE DIRECTION OF TRAVEL AND A MAXIMUM CROSS SLOPE OF 2%. NEW PAVED SURFACES SHALL HAVE A MINIMUM SLOPE OF 1.0%.
2. THE CONTRACTOR SHALL ESTABLISH FINISHED ELEVATIONS AND SLOPES AND SHALL CONTACT THE LANDSCAPE ARCHITECT AND OWNER FOR REVIEW AND APPROVAL OF THOSE ELEVATIONS PRIOR TO POURING CONCRETE. CONTACT LANDSCAPE ARCHITECT AND OWNER FOR APPROVAL OF GRADES, SLOPES AND ELEVATIONS PRIOR TO POURING CONCRETE.
3. FOR EXCAVATION WITHIN THE ROOT ZONE OF EXISTING TREES, NOTIFY THE LANDSCAPE ARCHITECT AND OWNER IF TREE ROOTS LARGER THAN 2" MUST BE CUT TO ACHIEVE GRADES. CUT ROOTS CLEANLY. DO NOT TEAR ROOTS.
4. FOR TURF AREAS, BRING FINISHED GRADE TO WITHIN 1" OF FINISHED ADJACENT SIDEWALKS AFTER THE ADDITION OF SOIL AMENDMENTS. REFER TO SPECIFICATIONS FOR SOIL AMENDMENT REQUIREMENTS.
5. FOR MULCHED AREAS (TREE, SHRUB AND GROUND COVER AREAS), BRING FINISHED GRADE TO WITHIN 3" OF ADJACENT SIDEWALKS AFTER THE ADDITION OF SOIL AMENDMENTS. REFER TO SPECIFICATIONS FOR SOIL AMENDMENT REQUIREMENTS.
6. ADD SCREENED TOPSOIL WHERE REQUIRED TO BRING FINISHED GRADE TO FINAL LEVELS FOR PLANTING. REFER TO PLANTING SPECIFICATIONS FOR TOPSOIL REQUIREMENTS. REMOVE SOIL AS REQUIRED AND DISPOSE OF OFF SITE AFTER AMENDMENT TO MAINTAIN NECESSARY GRADES.



822 West Liberty Street
 Sumter, SC

**Sister
 Wimberly
 Playground**

J&VP
 Jones and VanPatten, LLC
 Civil Engineers
 PO Box 567
 232 West Calhoun Street
 Sumter, SC 29151
 Phone: (803) 774-2127
 Fax: (803) 775-8747

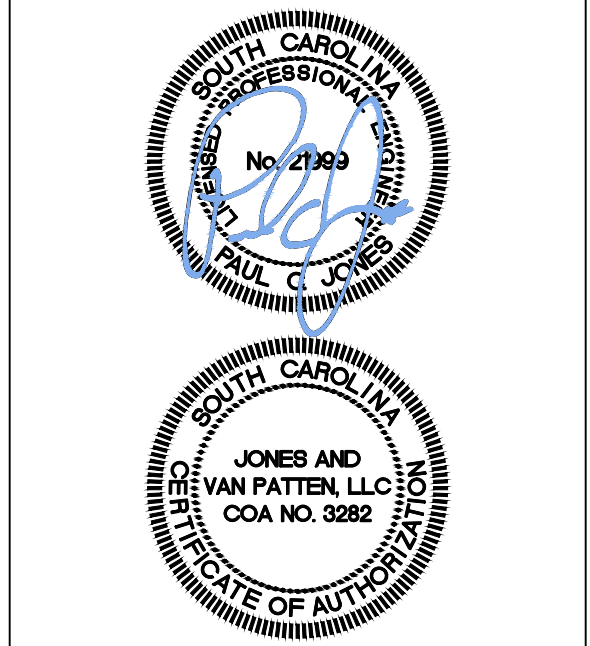

**MCIVER
 LANDSCAPE
 ARCHITECTURE**
 7 1/2 S. MAIN ST SUMTER, SC 29150
 803-968-3992 INFO@MCIVERLA.COM

SEPT. 29, 2025

REV. DATE	NAME
10-30-2025	ADDENDUM #2

**GRADING
 PLAN**

L2.2

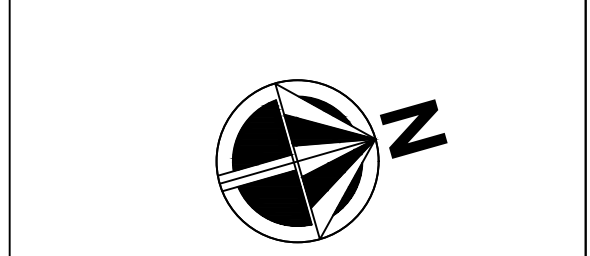

0' 10' 20'
 SCALE 1" = 20' - 0"

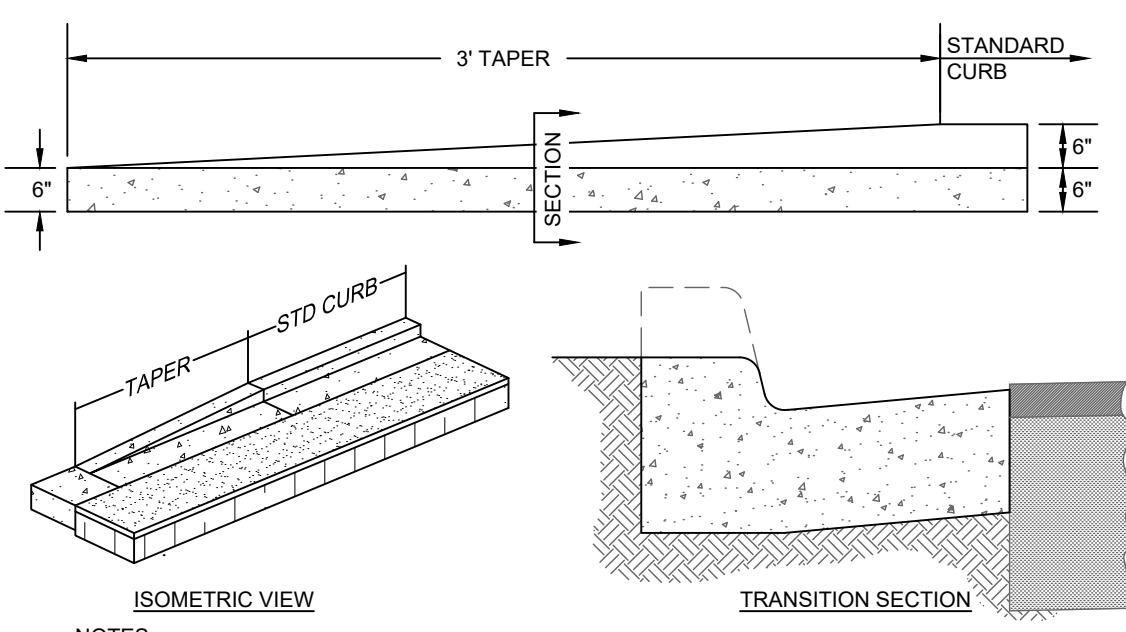

- NOTES:**
- USE TRANSITION CURBS AT THE END OF CURB AND GUTTER SECTIONS AND WHERE DROPPED CURBS ARE REQUIRED.
 - STRAIGHT BACK CURB SHOWN. TRANSITION IS SIMILAR FOR OTHER CURB SECTIONS AND FOR TRANSITION FROM STRAIGHT CURB TO ROLL CURB.

15 CURB TAPER No Scale

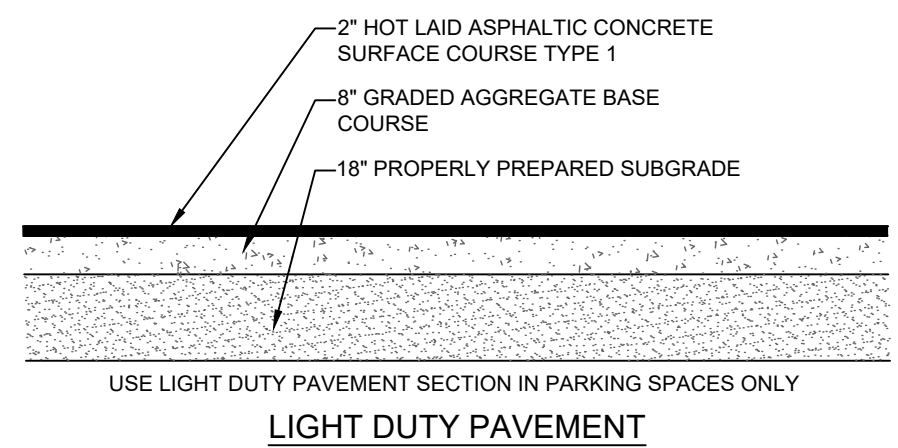

LIGHT DUTY PAVEMENT

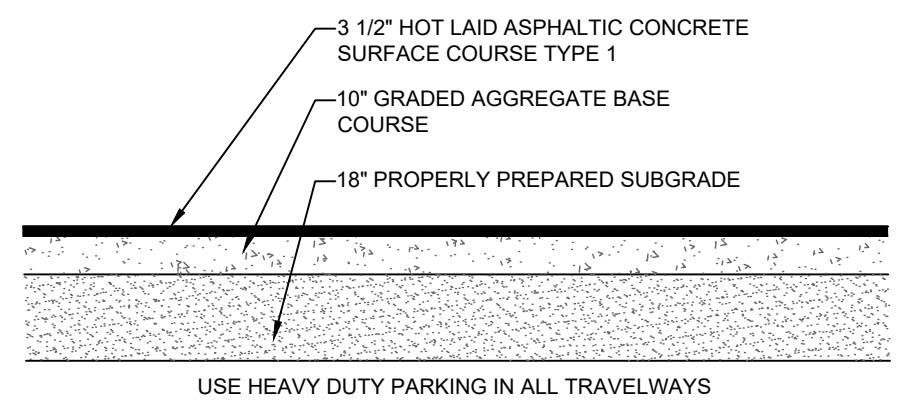

HEAVY DUTY PAVEMENT

- THIS SECTION IS AS SPECIFIED IN THE LETTER OF PAVEMENT RECOMMENDATION PROVIDED BY GS2, PROJECT NUMBER 17-12987-G DATED JUNE 23, 2017. THE REPORT SHALL BE CONSIDERED PART OF THESE PLANS.
- IN CASE THE REPORT AND THESE PLANS DIFFER, THE GS2 REPORT SHALL GOVERN.
- THE ASPHALT SURFACE COURSE SHALL CONFORM TO SCDOT STANDARD SPECIFICATION, SECTION 403 FOR TYPE 1 HOT LAID ASPHALT CONCRETE SURFACE COURSE.
- THE BASE COURSE MATERIAL SHALL BE GRADED AGGREGATE BASE COURSE CONFORMING TO SCDOT STANDARD SPECIFICATION SECTION 305. THE BASE COURSE SHALL BE COMPACTED TO 100% MODIFIED PROCTOR MAXIMUM DRY DENSITY.

19 ASPHALT PAVEMENT SECTIONS No Scale

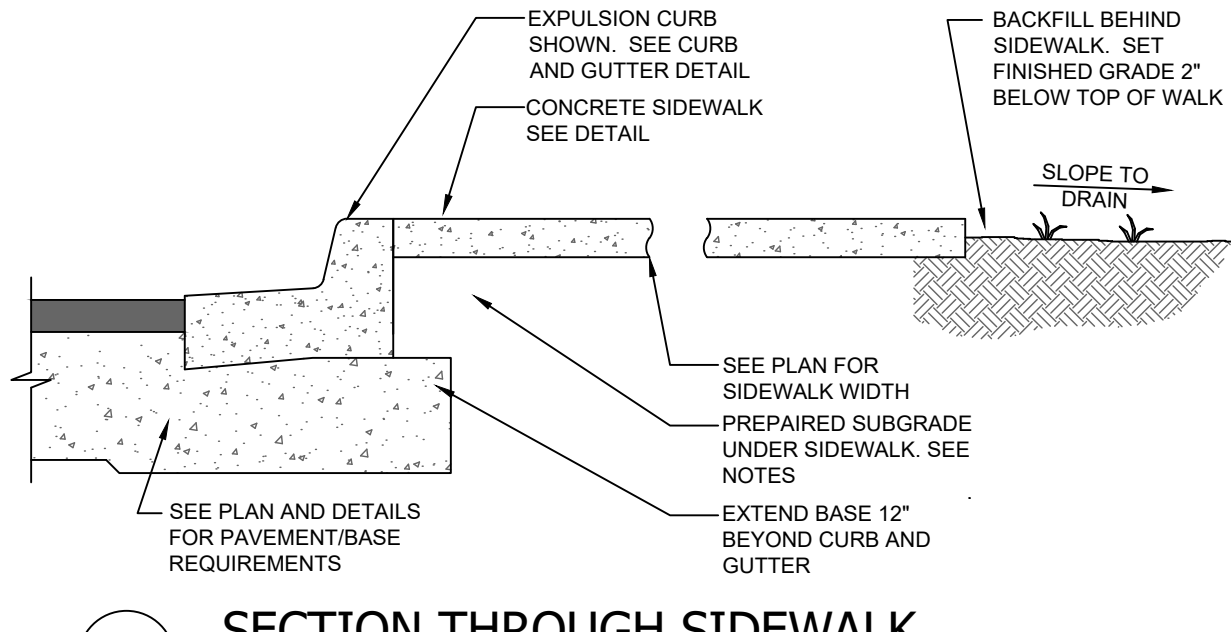

11 SECTION THROUGH SIDEWALK No Scale

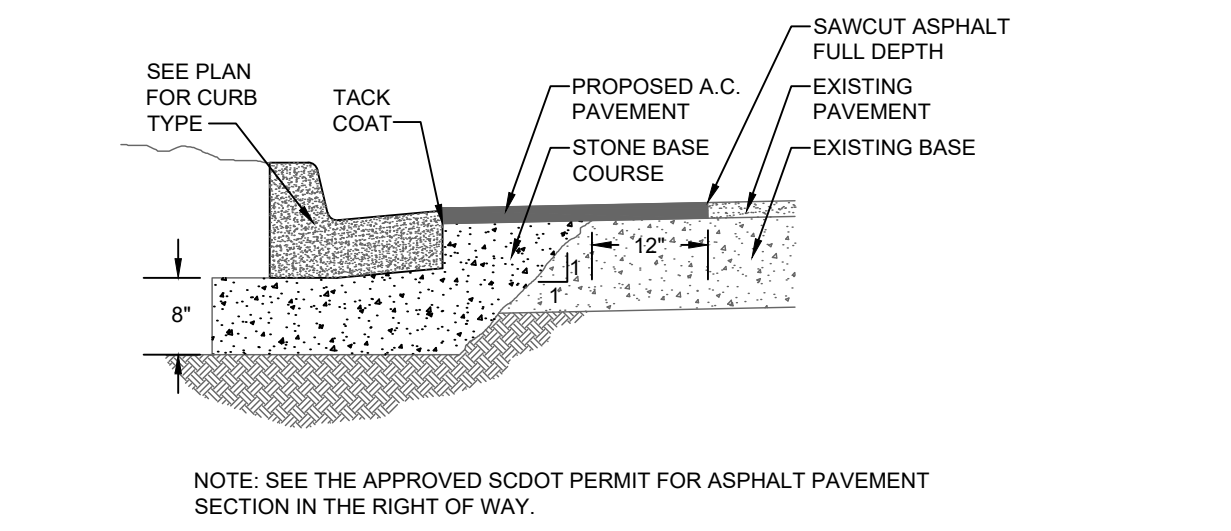

12 CURB ADJACENT TO EXIST. PAV. No Scale

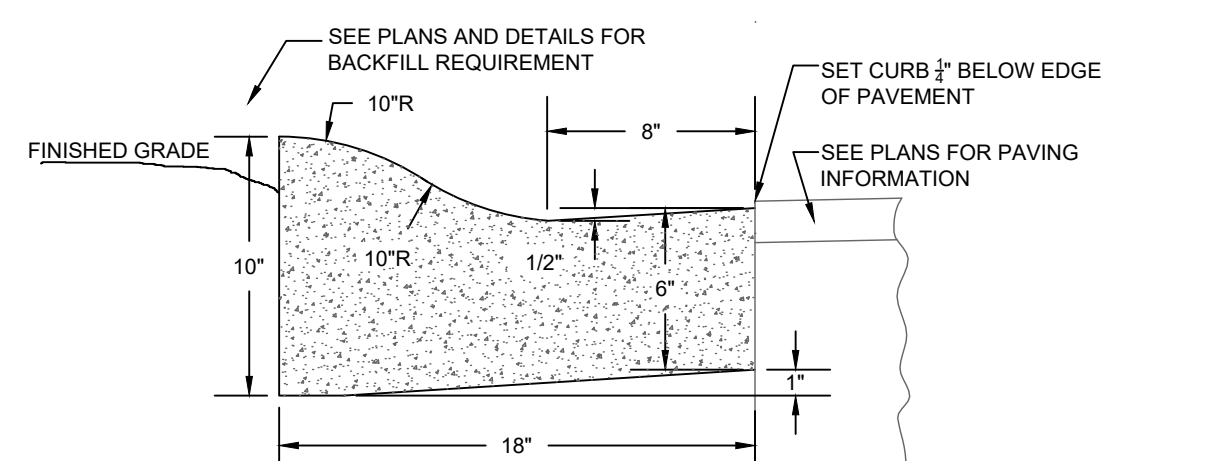

13 CONCRETE ROLL CURB No Scale

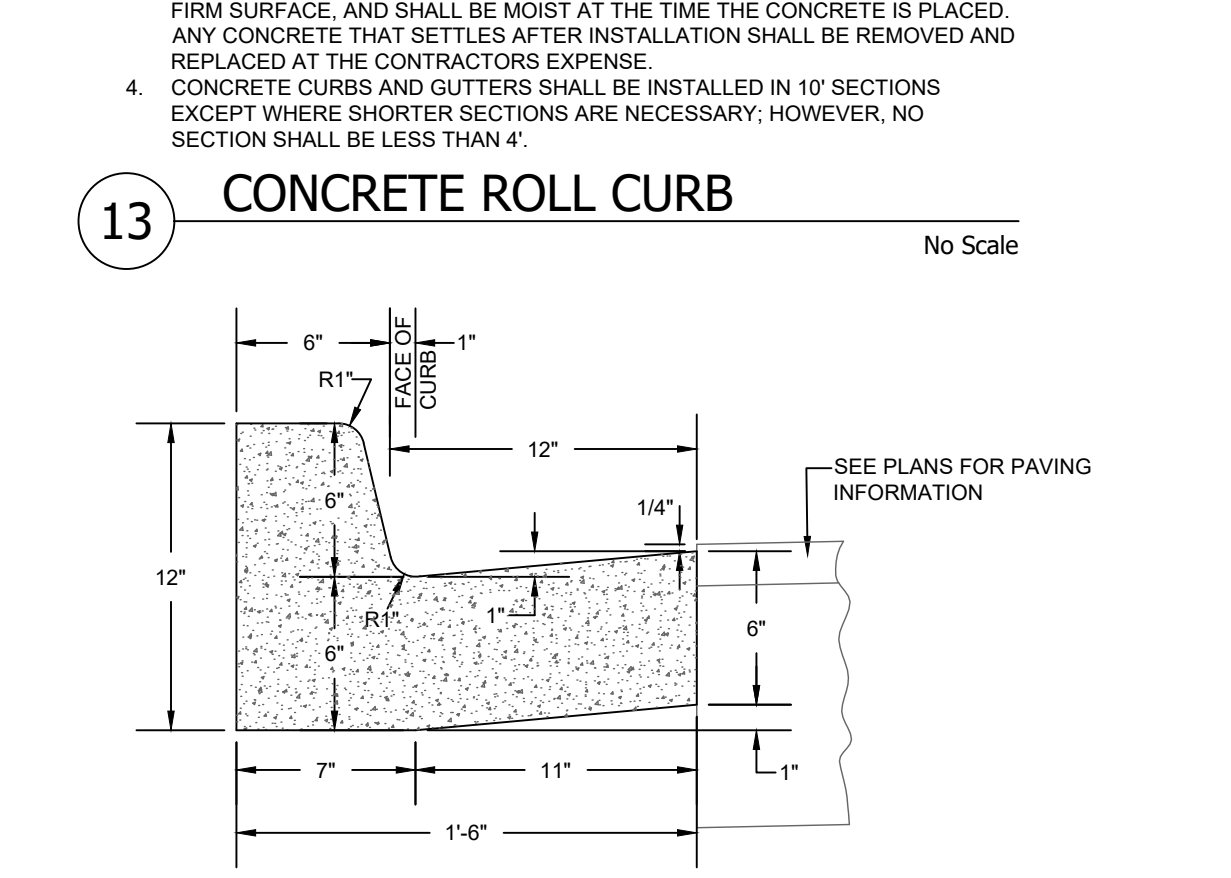

5 PRECAST CONCRETE WHEELSTOP No Scale

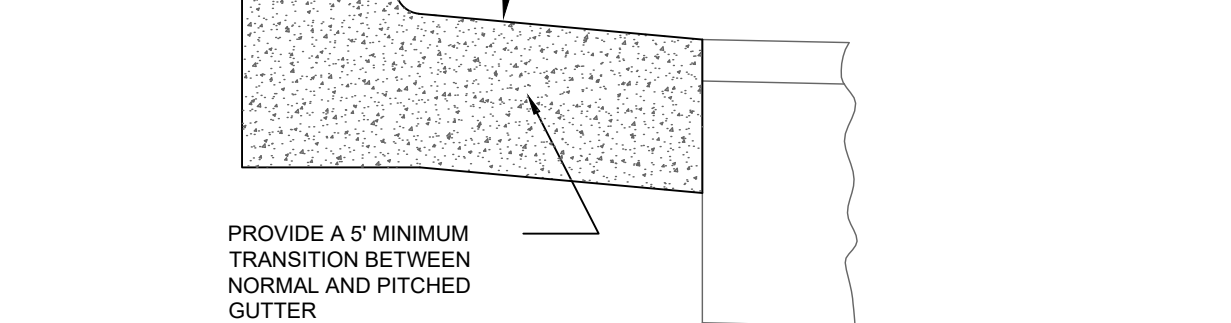

14 18" CONCRETE CURB & GUTTER No Scale

- NOTES:**
- CONCRETE CURB AND GUTTER SHALL BE INSTALLED PER SCDOT STANDARD SPECIFICATIONS FOR HIGHWAY CONSTRUCTION, LATEST EDITION, SECTION 720, AND PER SCDOT STANDARD DRAWING NO. 720-1.
 - USE THREE (3) FOOT CURB END TAPER AT TERMINATING END SECTIONS.
 - SUBGRADE SHALL BE THOROUGHLY COMPACTED, FINISHED TO A SMOOTH, FIRM SURFACE, AND SHALL BE MOIST AT THE TIME THE CONCRETE IS PLACED. ANY CONCRETE THAT SETTLES AFTER INSTALLATION SHALL BE REMOVED AND REPLACED AT THE CONTRACTOR'S EXPENSE.
 - CONCRETE CURBS AND GUTTERS SHALL BE INSTALLED IN 10' SECTIONS EXCEPT WHERE SHORTER SECTIONS ARE NECESSARY; HOWEVER, NO SECTION SHALL BE LESS THAN 4'.
 - MAKE WEAKENED JOINTS, SPACED AT 10 FOOT INTERVALS, BY CUTTING THE PLASTIC CONCRETE WITH A TROWEL OR BY OTHER DETECTABLE METHODS. ENSURE THAT THE MANNER OF CONSTRUCTION OF JOINTS MEETS THE APPROVAL OF THE SITE SUPERVISOR AND HAS A WORKMANLIKE FINISH AFTER EDGING.

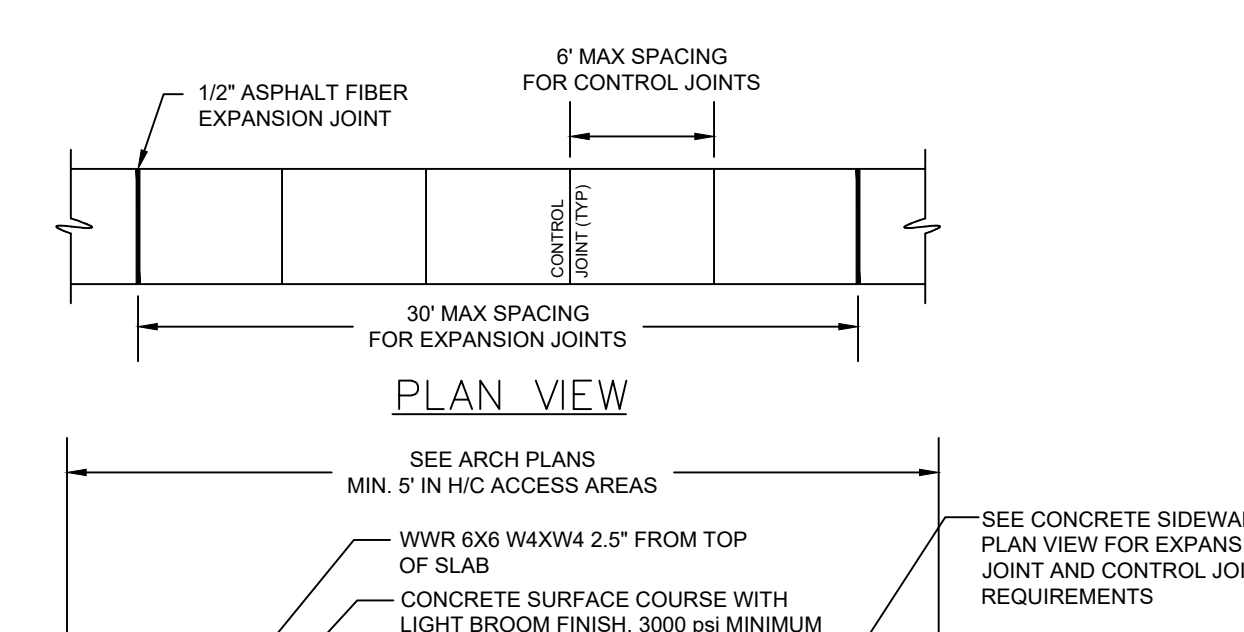

PLAN VIEW

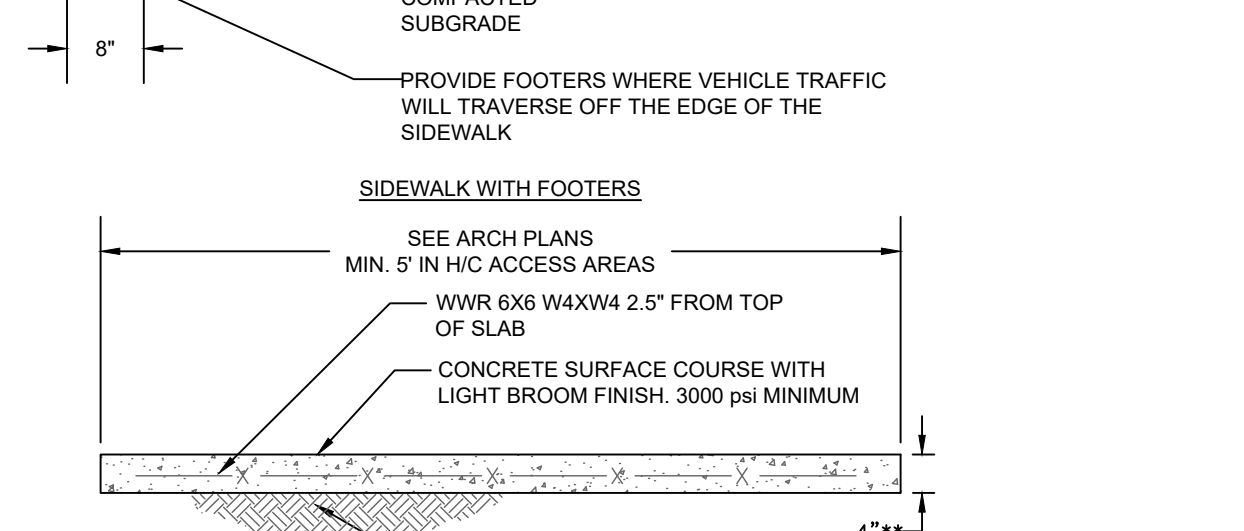

CONCRETE SIDEWALK NOTES:

- General**
- Compliance: All work shall conform to the SCDOT Standard Specifications for Highway Construction (2025 Edition) and applicable SCDOT Standard Drawings.
 - Standard Drawings Reference: Refer to SCDOT Standard Drawings 720-150-00 and 720-155-00 for requirements.
 - Accessibility: Sidewalk shall comply with the 2010 ADA Standards for Accessible Design, ensuring a maximum cross slope of 1:48 and longitudinal slope not exceeding 1:20 unless matching existing conditions. Note that the maximum cross slope shown on the plans is 1.5%.
 - Integration: Match existing sidewalk grades and transitions where applicable, ensuring smooth connections to renovated sections.
- Materials**
- Concrete Mix: Use SCDOT-approved concrete mix with a minimum compressive strength of 3000 psi at 28 days, per Section 300.2 (Concrete Materials).
 - Aggregate: Aggregate shall meet SCDOT gradation and quality standards, per Section 300.2.3.
 - Joint Filler: Expansion joint filler shall be performed, non-extruding material, full depth of slab, per Section 300.8.
- Construction**
- Thickness: Minimum sidewalk thickness shall be 4 inches, unless otherwise specified in plans.
 - Width: Sidewalk width shall be as shown on the plans.
 - Formwork: Forms shall be straight, aligned to line and grade, per Section 300.4.
 - Placement: Place concrete continuously, vibrate to eliminate voids, and finish to a smooth, even surface, per Sections 300.5 and 300.6.
 - Curing: Cure concrete for a minimum of 7 days using moist curing methods, per Section 300.7.
 - Expansion Joints: Install expansion joints every 20 feet with full-depth filler, recessed and sealed, per Section 300.8.
 - Control Joints: Provide contraction joints every 5 feet, tooled or sawed to 1/4 slab depth.
 - All joints and edges shall be tooled.

9 CONCRETE SIDEWALK No Scale

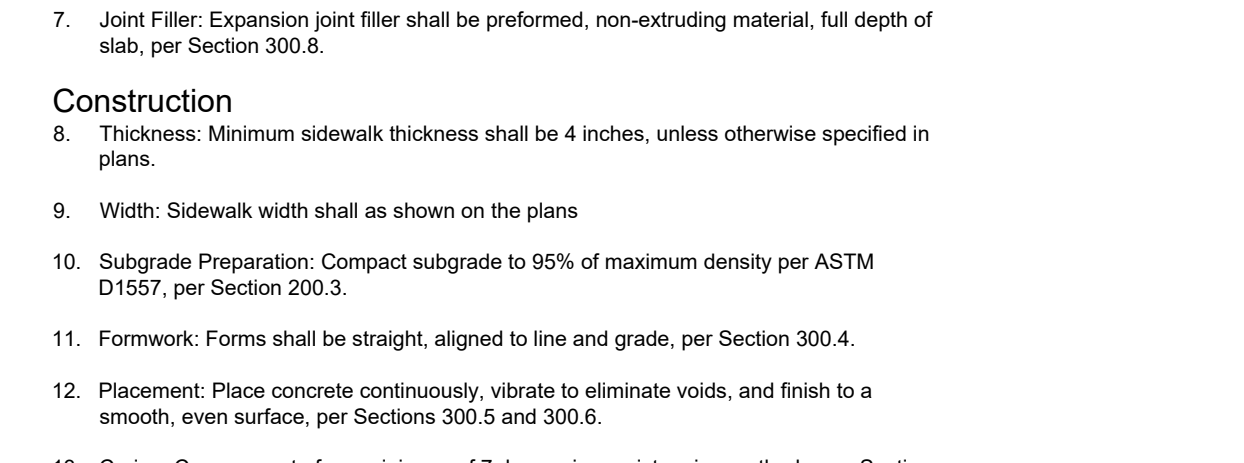

8 HANDICAP PARKING No Scale

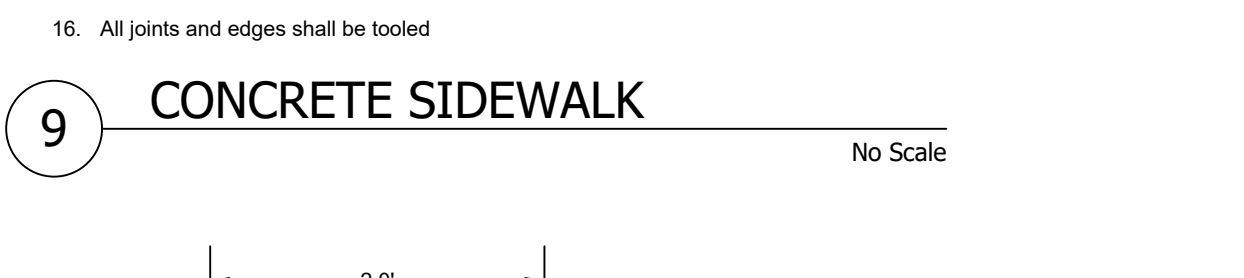

4 SECTION AT EDGE OF WALK No Scale

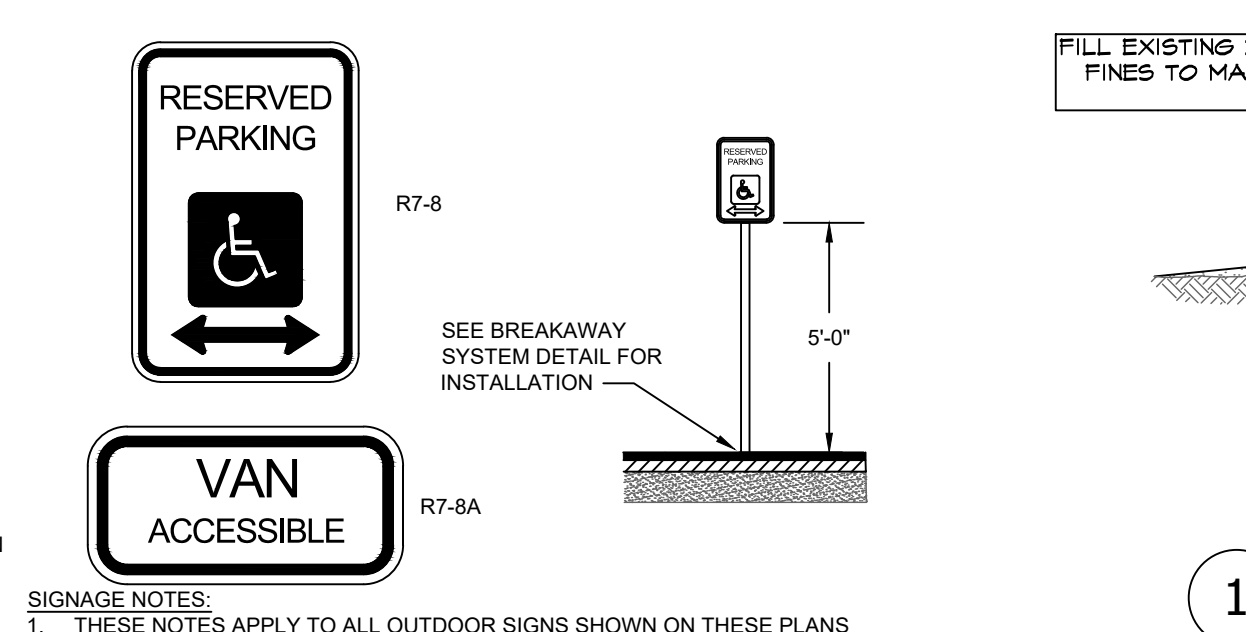

7 SIGN BREAKAWAY SYSTEM No Scale

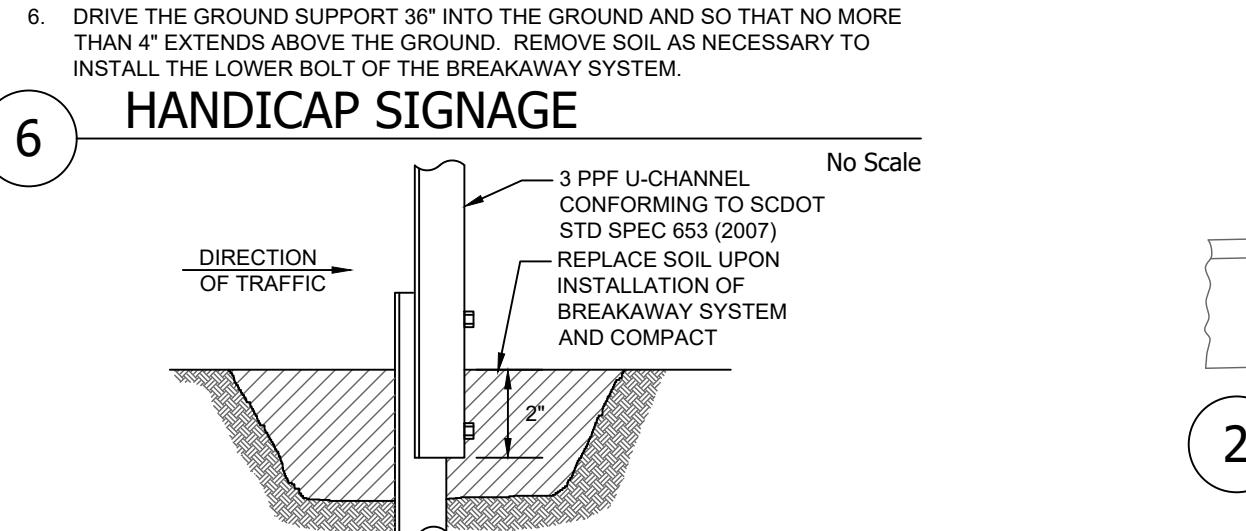

1 TIE IN TO EXISTING "DIRT DRIVE" No Scale

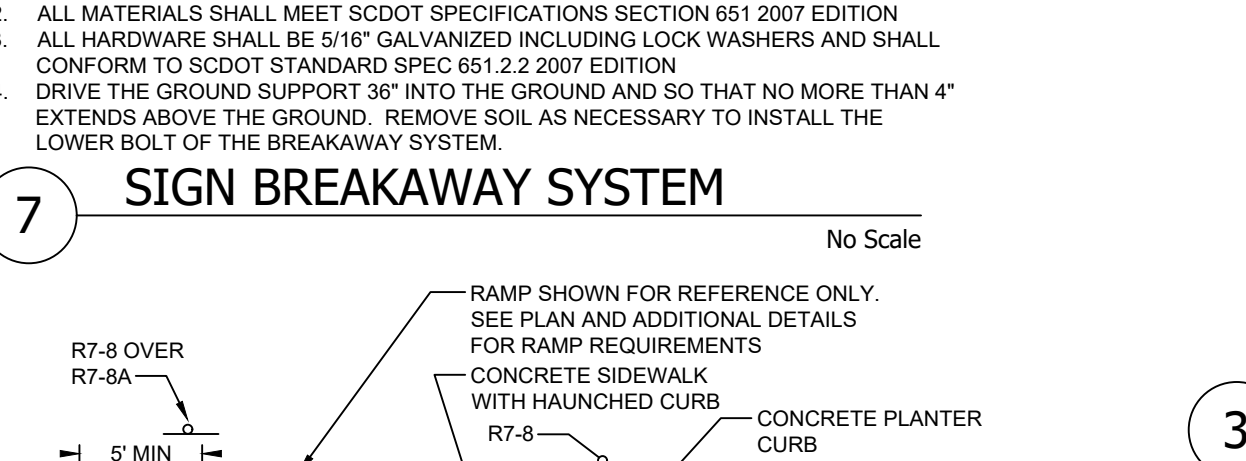

3 PAVE. ADJ. TO EXISTING PAVE. No Scale

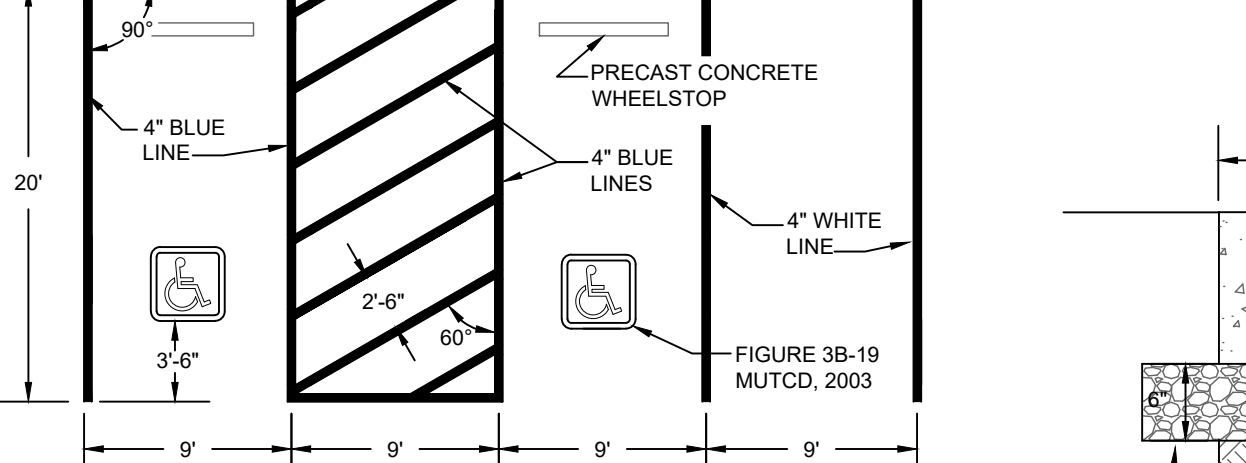

CONCRETE PAVEMENT NOTES

- THE BASE COURSE MATERIAL SHALL BE GRADED AGGREGATE BASE COURSE CONFORMING TO SCDOT STANDARD SPECIFICATION SECTION 305. THE BASE COURSE SHALL BE COMPACTED TO 100% OF THE LABORATORY MODIFIED PROCTOR (ASTM D1557) MAXIMUM DRY DENSITY.
- CONCRETE SHALL HAVE A MINIMUM 28-DAY COMPRESSIVE STRENGTH OF 5000 PSI AND 650 PSI FLEXURAL STRENGTH. CONCRETE SHALL CONFORM TO SCDOT STANDARD SPECIFICATION SECTION 701 (LATEST EDITION).
- THE SUB-GRADE SHALL BE WELL DRAINAGE AND PROVIDE A FIRM UNIFORM SUPPORT FOR THE SUB-BASE MATERIAL. ALL SOD AND OTHER ORGANIC MATTER SHALL BE STRIPPED FROM THE SUB-GRADE.
- SPLICES OF WELDED WIRE FABRIC SHEETS SHALL BE PROVIDED BY OVERLAPPING (3) CROSS-WIRES. WELDED WIRE FABRIC SHALL BE SUPPORTED WITH PRECAST CONCRETE BRICKS (NOT CLAY BRICKS) OR METAL OR PLASTIC CHAIRS SPACED AT A MAXIMUM OF (24) INCHES CENTER-TO-CENTER (C-C). MINIMUM PROTECTIVE COVER SHALL BE (2) INCHES FROM FORMED SURFACES AND (3) INCHES FROM EARTH SURFACES OR GRAVEL BASE.
- FIBER MESH IS NOT ALLOWED AS AN ALTERNATE TO STEEL REINFORCEMENT MEMBERS.
- EXPANSION JOINTS FILLED WITH (1/2) INCH ASPHALT TREATED FIBER BOARD SHALL BE PLACED ALONG EXISTING STRUCTURES SUCH AS BUILDINGS, CONCRETE TANKS OR CONCRETE SLABS UNLESS OTHERWISE INDICATED.
- CONTROL JOINTS SHALL BE FORMED IN FRESH CONCRETE EITHER BY HAND TOOLING OR SAW CUTTING. JOINTS SHALL BE FORMED AS SOON AS PRACTICAL AFTER CONCRETE FINISHING, BUT IN NO CASE LATER THAN (8) HOURS AFTER CONCRETE HAS BEEN PLACED. CONTRACTION JOINTS SHALL BE FORMED TO A DEPTH OF (1/4) OF SLAB THICKNESS. CONTROL JOINTS SHALL BE SEALED WITH AN ELASTOMERIC JOINT SEALER MEETING ASTM C-920 IN ACCORDANCE WITH THE MANUFACTURER'S DIRECTIONS.
- IN ALL CASES CONCRETE SHALL BE CURED BY KEEPING THE SURFACE COOL AND MOIST FOR (7) DAYS AFTER PLACEMENT.
- IN HOT WEATHER, THE CONCRETE TEMPERATURE SHALL BE MAINTAINED BELOW 85°F DURING MIXING, CONVEYING AND PLACEMENT. CONCRETE MUST THEN BE KEPT MOIST AT ALL TIMES FOR AT LEAST (7) DAYS OR UNTIL CURING COMPOUND IS APPLIED AS IN PREVIOUS PARAGRAPH.
- IN COLD WEATHER CONCRETE SHALL NOT BE MIXED OR PLACED WHEN DAILY ATMOSPHERIC TEMPERATURE IS LESS THAN 40°F UNLESS FACILITIES ARE PROVIDED TO PREVENT CONCRETE FROM FREEZING. THE USE OF ACCELERATORS OR ANTIFREEZE COMPOUNDS WILL NOT BE PERMITTED. THE TEMPERATURE OF THE CONCRETE AT THE TIME OF PLACING SHALL NOT BE LESS THAN 50°F AND SHALL BE MAINTAINED AT TEMPERATURES NOT LESS THAN 40°F FOR A PERIOD OF (3) DAYS. THERMAL BLANKETS IF USED SHALL HAVE SUFFICIENT R-VALUE TO PROTECT CONCRETE FOR THE EXPECTED TEMPERATURES.

18 CONCRETE PAVEMENT No Scale

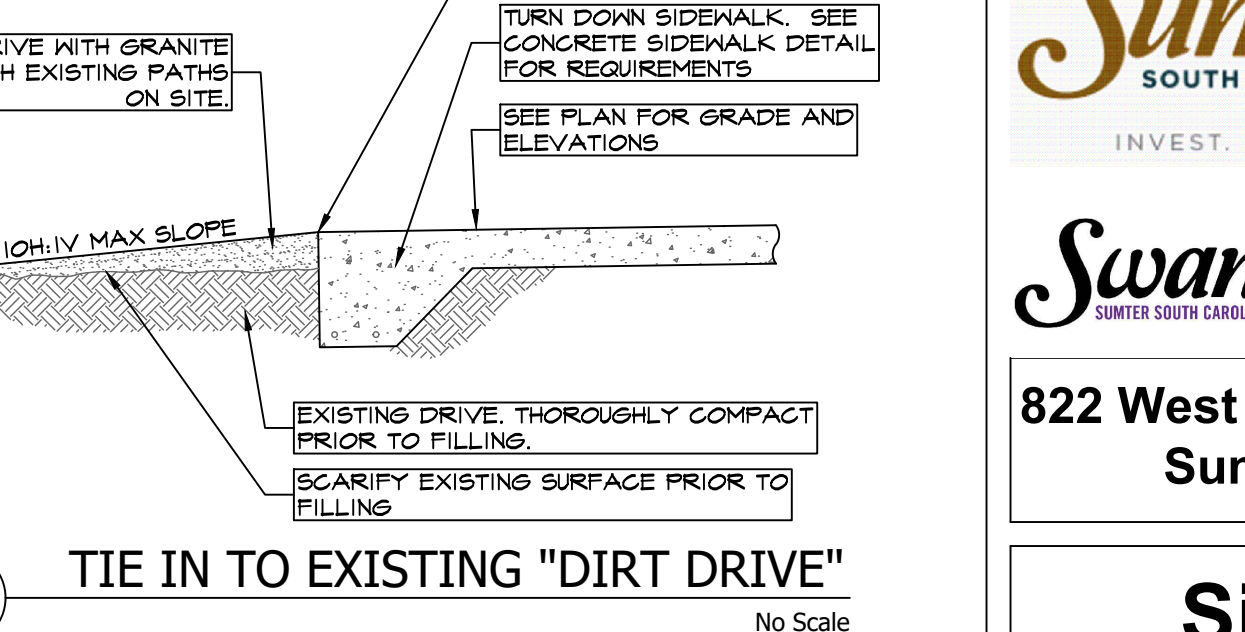

1 TIE IN TO EXISTING "DIRT DRIVE" No Scale

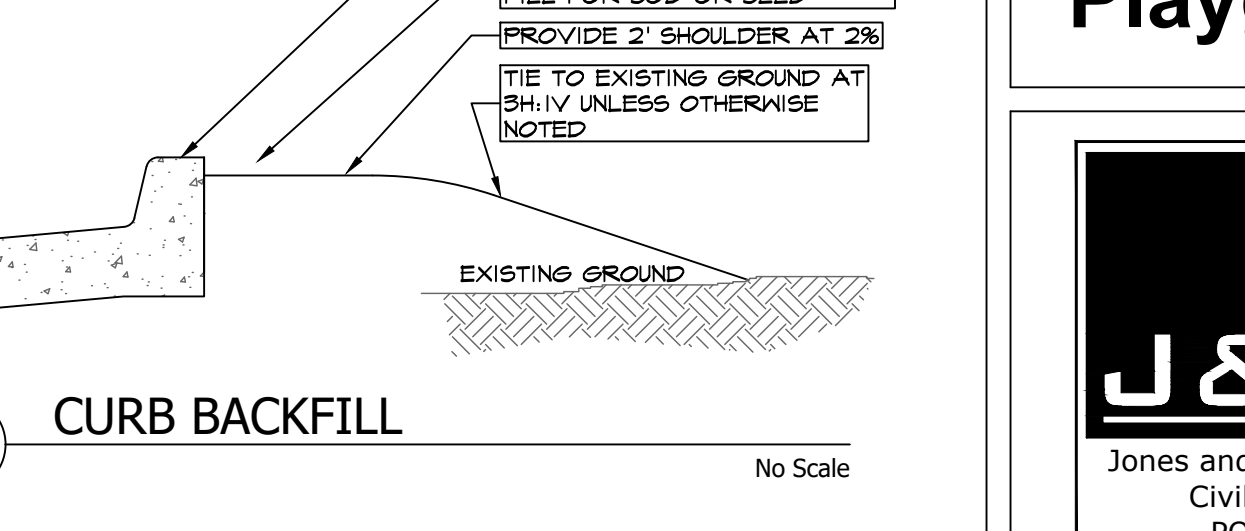

1 CURB BACKFILL No Scale

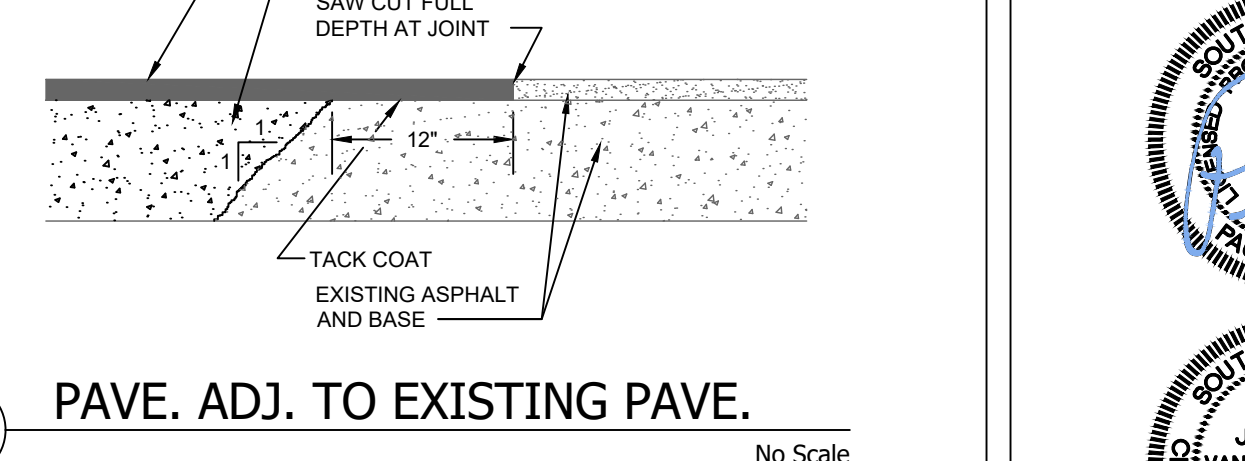

3 PAVE. ADJ. TO EXISTING PAVE. No Scale

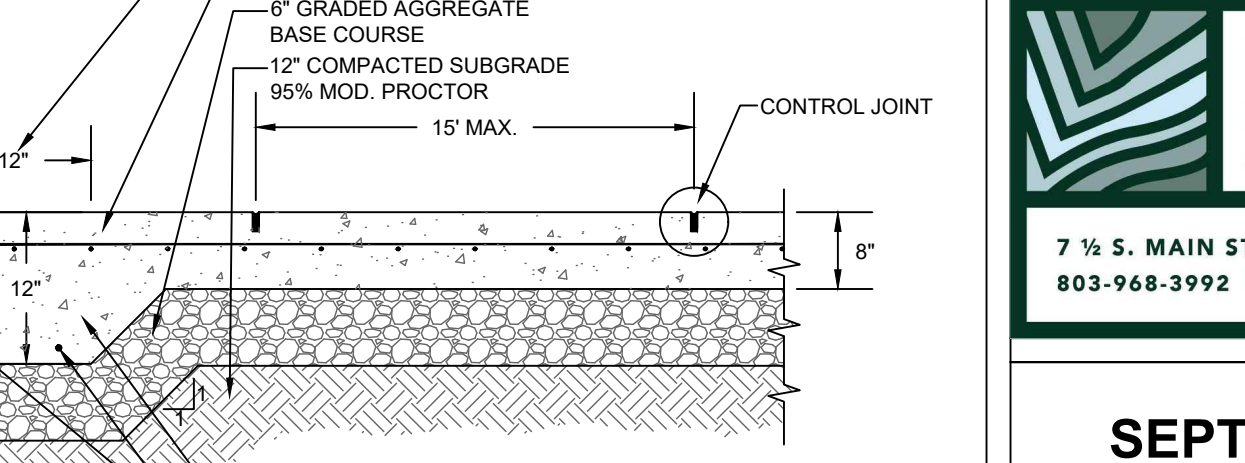

CONCRETE PAVEMENT NOTES

- THE BASE COURSE MATERIAL SHALL BE GRADED AGGREGATE BASE COURSE CONFORMING TO SCDOT STANDARD SPECIFICATION SECTION 305. THE BASE COURSE SHALL BE COMPACTED TO 100% OF THE LABORATORY MODIFIED PROCTOR (ASTM D1557) MAXIMUM DRY DENSITY.
- CONCRETE SHALL HAVE A MINIMUM 28-DAY COMPRESSIVE STRENGTH OF 5000 PSI AND 650 PSI FLEXURAL STRENGTH. CONCRETE SHALL CONFORM TO SCDOT STANDARD SPECIFICATION SECTION 701 (LATEST EDITION).
- THE SUB-GRADE SHALL BE WELL DRAINAGE AND PROVIDE A FIRM UNIFORM SUPPORT FOR THE SUB-BASE MATERIAL. ALL SOD AND OTHER ORGANIC MATTER SHALL BE STRIPPED FROM THE SUB-GRADE.
- SPLICES OF WELDED WIRE FABRIC SHEETS SHALL BE PROVIDED BY OVERLAPPING (3) CROSS-WIRES. WELDED WIRE FABRIC SHALL BE SUPPORTED WITH PRECAST CONCRETE BRICKS (NOT CLAY BRICKS) OR METAL OR PLASTIC CHAIRS SPACED AT A MAXIMUM OF (24) INCHES CENTER-TO-CENTER (C-C). MINIMUM PROTECTIVE COVER SHALL BE (2) INCHES FROM FORMED SURFACES AND (3) INCHES FROM EARTH SURFACES OR GRAVEL BASE.
- FIBER MESH IS NOT ALLOWED AS AN ALTERNATE TO STEEL REINFORCEMENT MEMBERS.
- EXPANSION JOINTS FILLED WITH (1/2) INCH ASPHALT TREATED FIBER BOARD SHALL BE PLACED ALONG EXISTING STRUCTURES SUCH AS BUILDINGS, CONCRETE TANKS OR CONCRETE SLABS UNLESS OTHERWISE INDICATED.
- CONTROL JOINTS SHALL BE FORMED IN FRESH CONCRETE EITHER BY HAND TOOLING OR SAW CUTTING. JOINTS SHALL BE FORMED AS SOON AS PRACTICAL AFTER CONCRETE FINISHING, BUT IN NO CASE LATER THAN (8) HOURS AFTER CONCRETE HAS BEEN PLACED. CONTRACTION JOINTS SHALL BE FORMED TO A DEPTH OF (1/4) OF SLAB THICKNESS. CONTROL JOINTS SHALL BE SEALED WITH AN ELASTOMERIC JOINT SEALER MEETING ASTM C-920 IN ACCORDANCE WITH THE MANUFACTURER'S DIRECTIONS.
- IN ALL CASES CONCRETE SHALL BE CURED BY KEEPING THE SURFACE COOL AND MOIST FOR (7) DAYS AFTER PLACEMENT.
- IN HOT WEATHER, THE CONCRETE TEMPERATURE SHALL BE MAINTAINED BELOW 85°F DURING MIXING, CONVEYING AND PLACEMENT. CONCRETE MUST THEN BE KEPT MOIST AT ALL TIMES FOR AT LEAST (7) DAYS OR UNTIL CURING COMPOUND IS APPLIED AS IN PREVIOUS PARAGRAPH.
- IN COLD WEATHER CONCRETE SHALL NOT BE MIXED OR PLACED WHEN DAILY ATMOSPHERIC TEMPERATURE IS LESS THAN 40°F UNLESS FACILITIES ARE PROVIDED TO PREVENT CONCRETE FROM FREEZING. THE USE OF ACCELERATORS OR ANTIFREEZE COMPOUNDS WILL NOT BE PERMITTED. THE TEMPERATURE OF THE CONCRETE AT THE TIME OF PLACING SHALL NOT BE LESS THAN 50°F AND SHALL BE MAINTAINED AT TEMPERATURES NOT LESS THAN 40°F FOR A PERIOD OF (3) DAYS. THERMAL BLANKETS IF USED SHALL HAVE SUFFICIENT R-VALUE TO PROTECT CONCRETE FOR THE EXPECTED TEMPERATURES.

18 CONCRETE PAVEMENT No Scale

CITY OF Sumter SOUTH CAROLINA
INVEST. INVITE. SERVE.

Swan Lake
SUMTER SOUTH CAROLINA

822 West Liberty Street
Sumter, SC

Sister Wimberly Playground

J&VP
Jones and VanPatten, LLC
Civil Engineers
PO Box 567
232 West Calhoun Street
Sumter, SC 29151
Phone: (803) 774-2127
Fax: (803) 775-8747

MSIVER LANDSCAPE ARCHITECTURE
7 1/2 S. MAIN ST. SUMTER, SC 29150
803-968-3992 INFO@MSIVERLA.COM

SEPT. 29, 2025

REV. DATE	NAME
10-30-2025	ADDENDUM #2

SITE AND GRADING DETAILS

L4.2

0' 10' 20'

SCALE 1" = 20'-0"

**Sister
Wimberly
Playground**

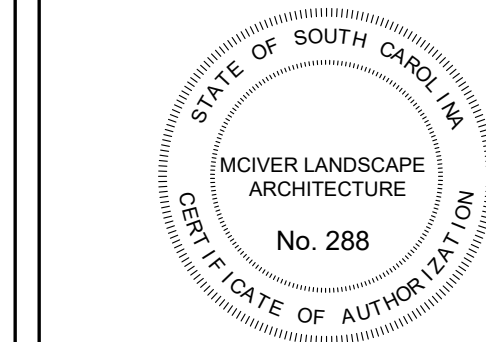

SEPT. 29, 2025

REV. DATE	NAME
10-30-25	BID ADDENDUM #2

SITE DETAILS

L6.1

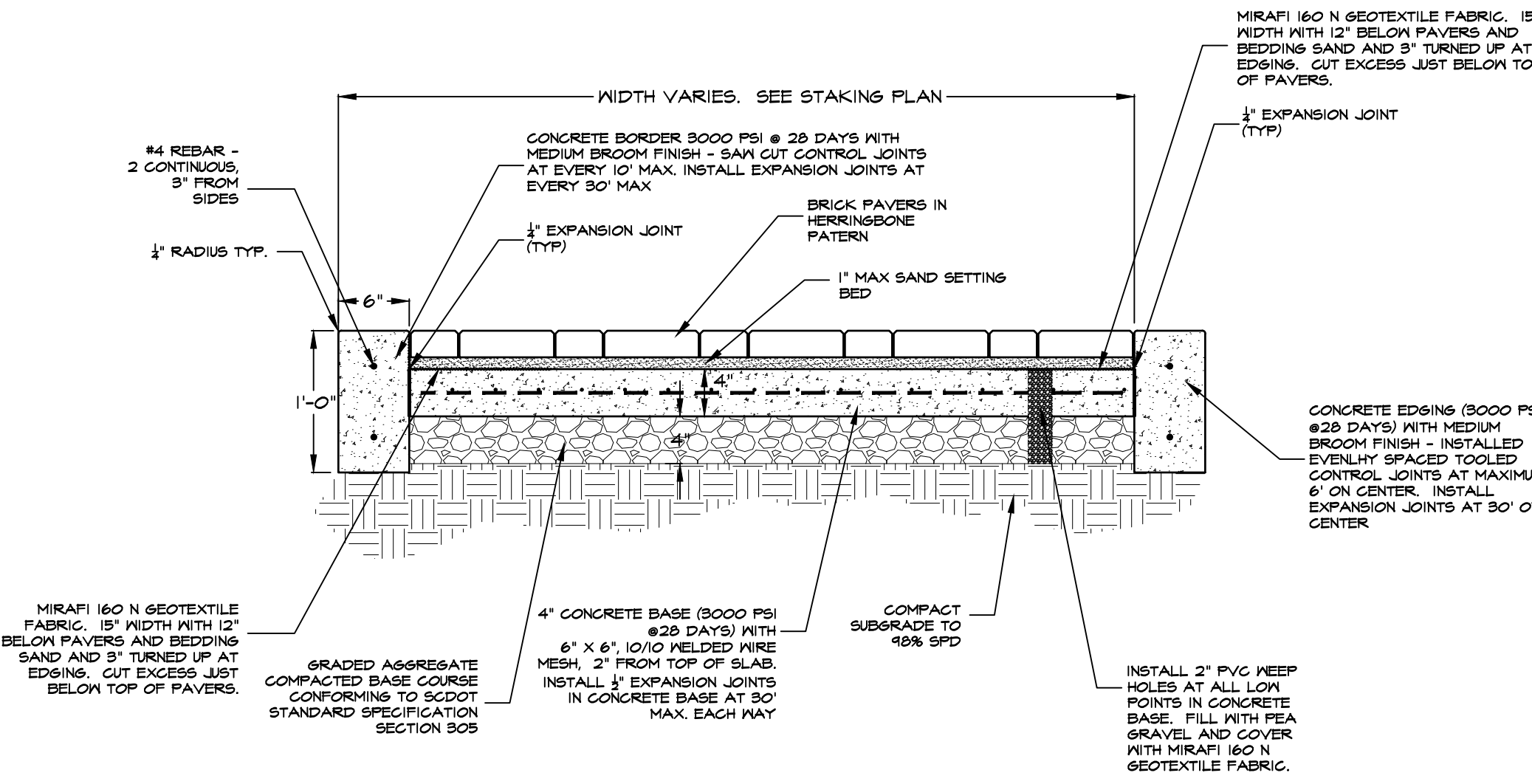

1 BRICK PAVERS WITH CONCRETE BORDER
L6.1 SECTION 1"=1'-0"

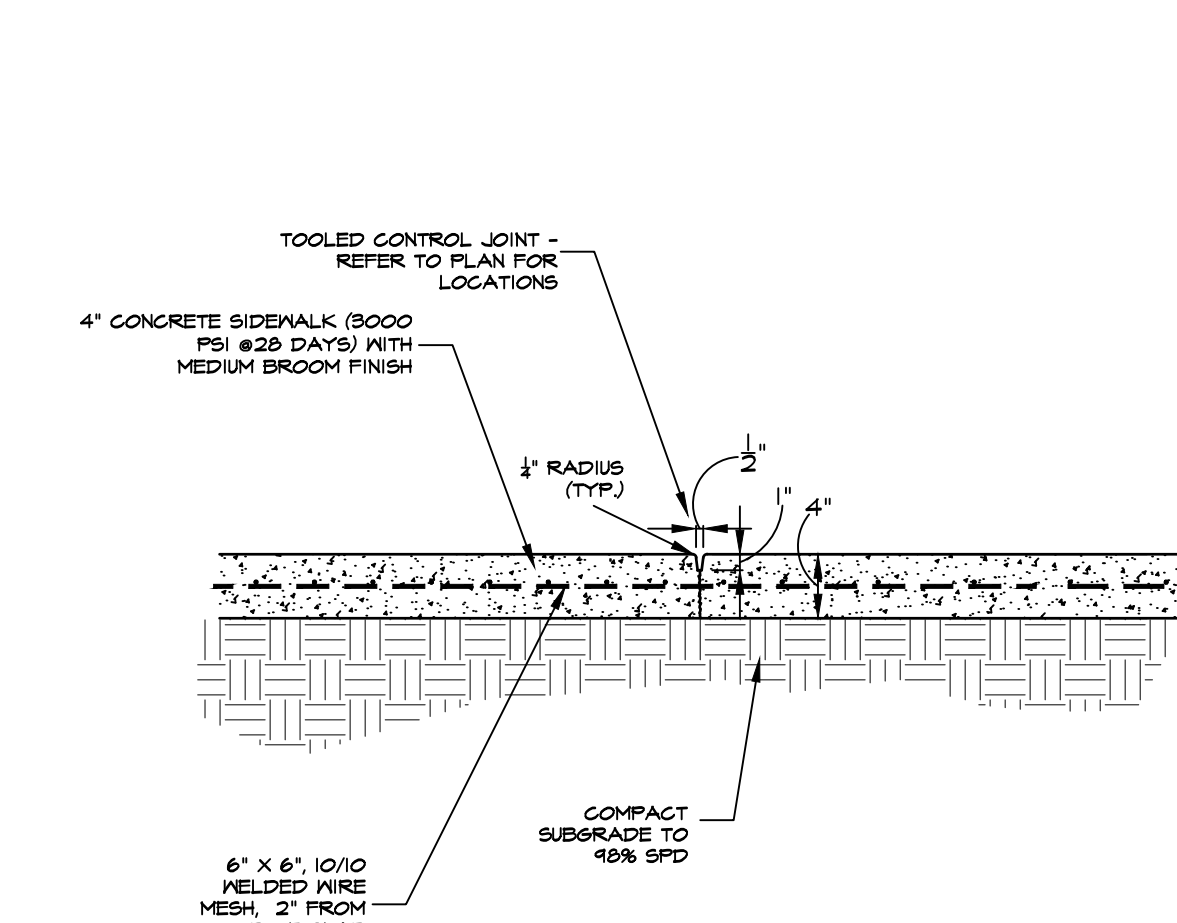

2 CONCRETE SIDEWALK
L6.1 SECTION 1"=1'-0"

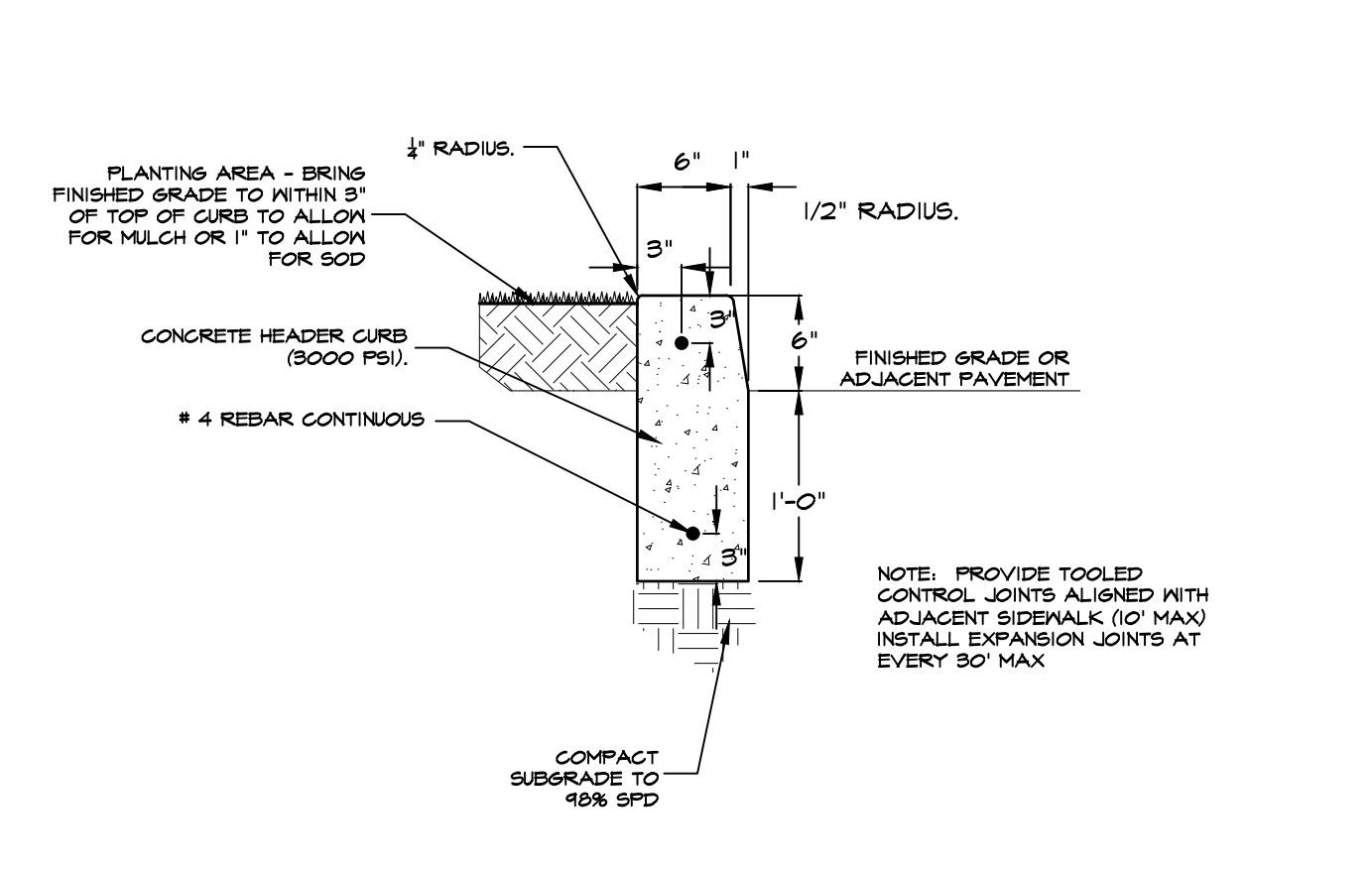

3 CONCRETE PLANTER CURB
L6.1 SECTION 1"=1'-0"

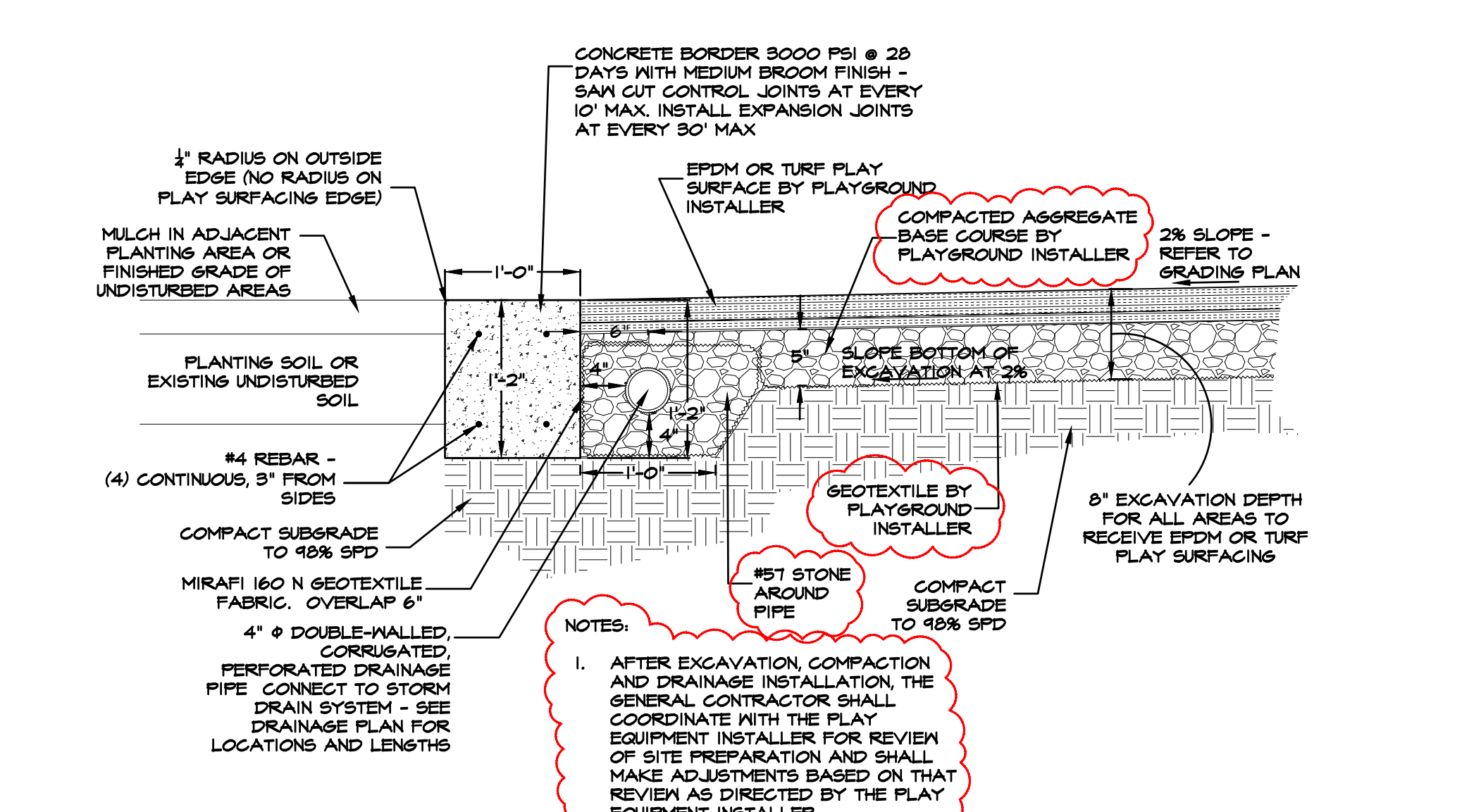

4 PLAYGROUND SURFACING AND CONCRETE BORDER
L6.1 SECTION 1"=1'-0"

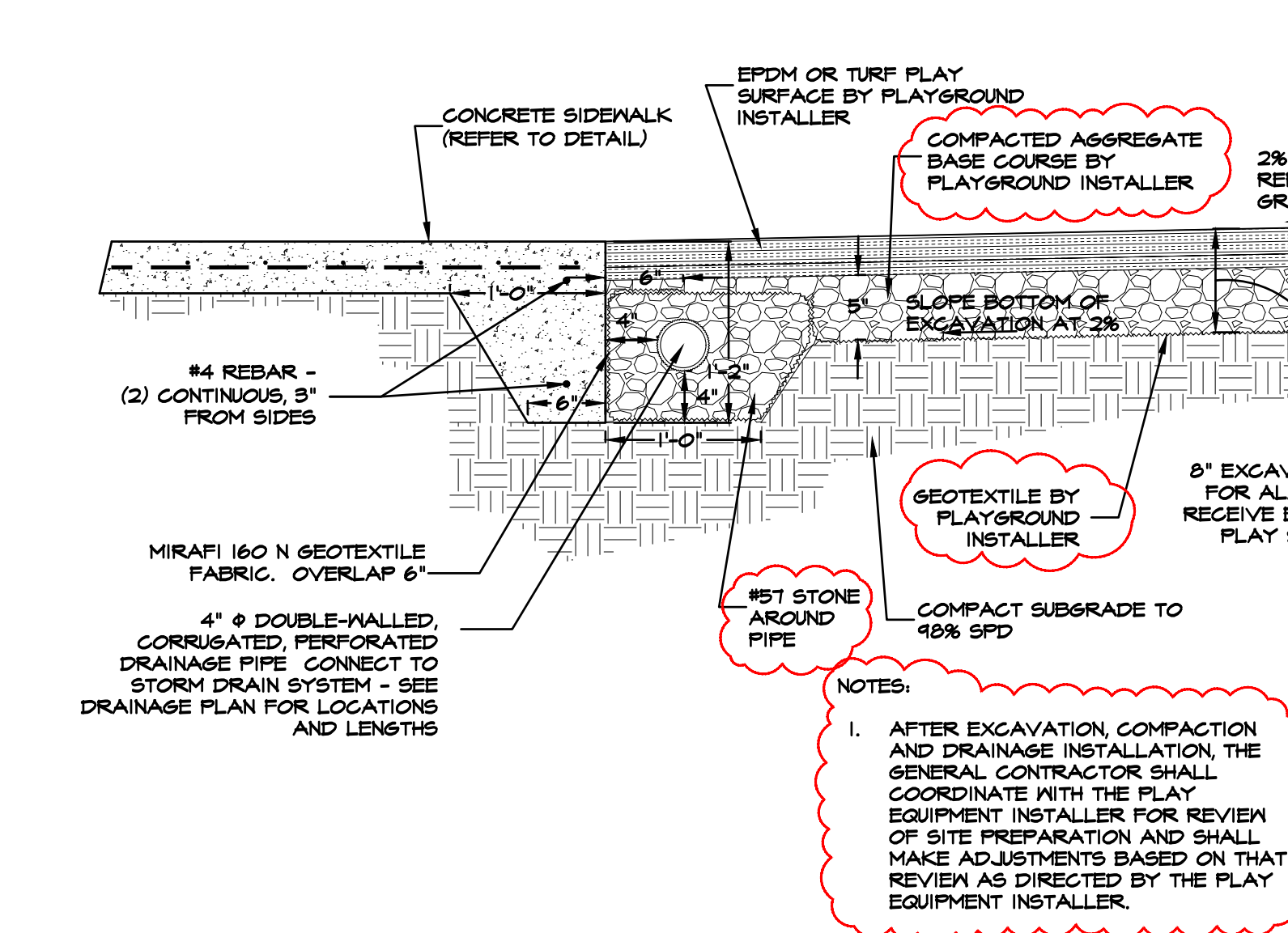

5 PLAYGROUND SURFACING AND SIDEWALK
L6.1 SECTION 1"=1'-0"

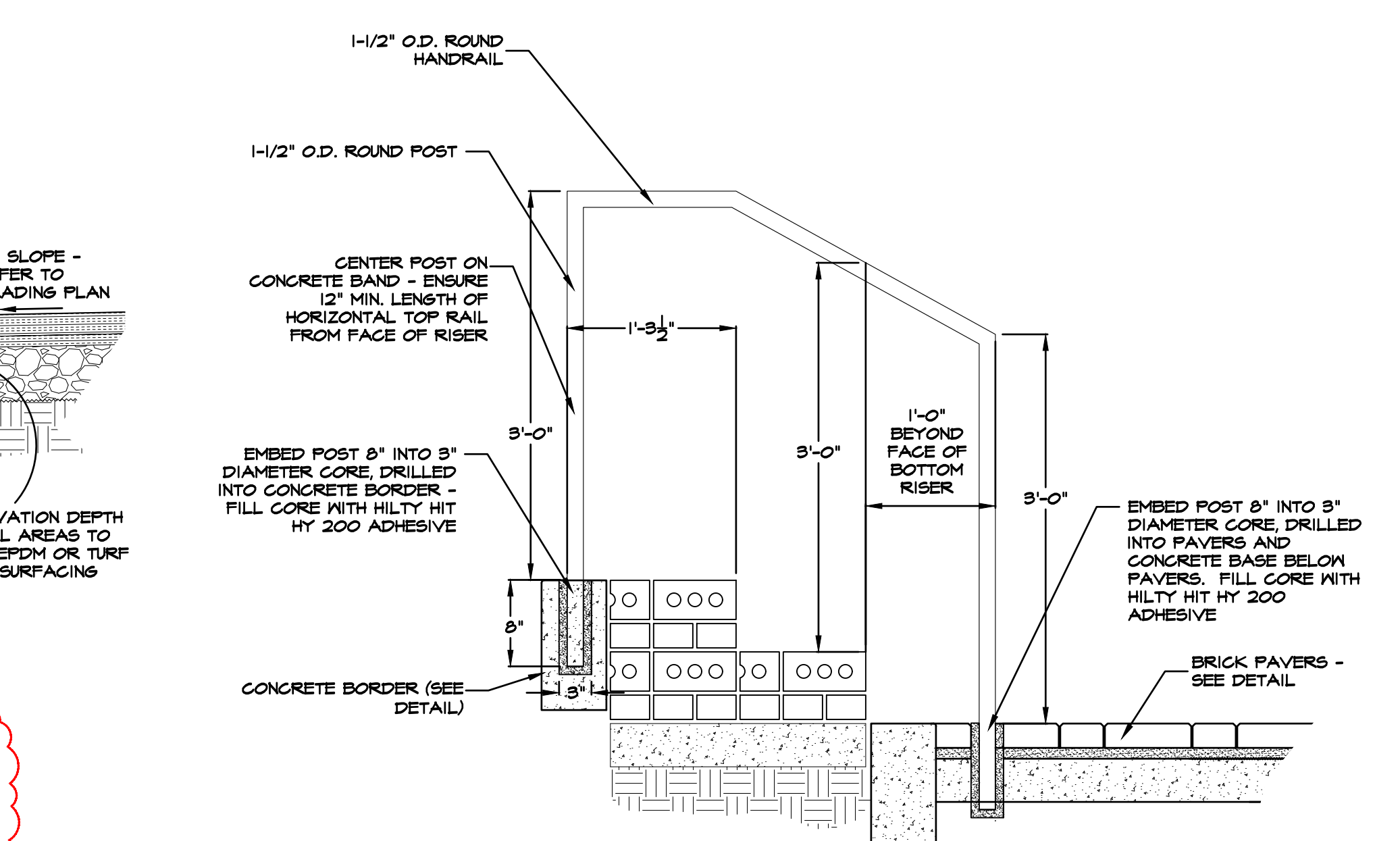

7 HANDRAILS AT BRICK STEPS
L6.1 SECTION 1"=1'-0"

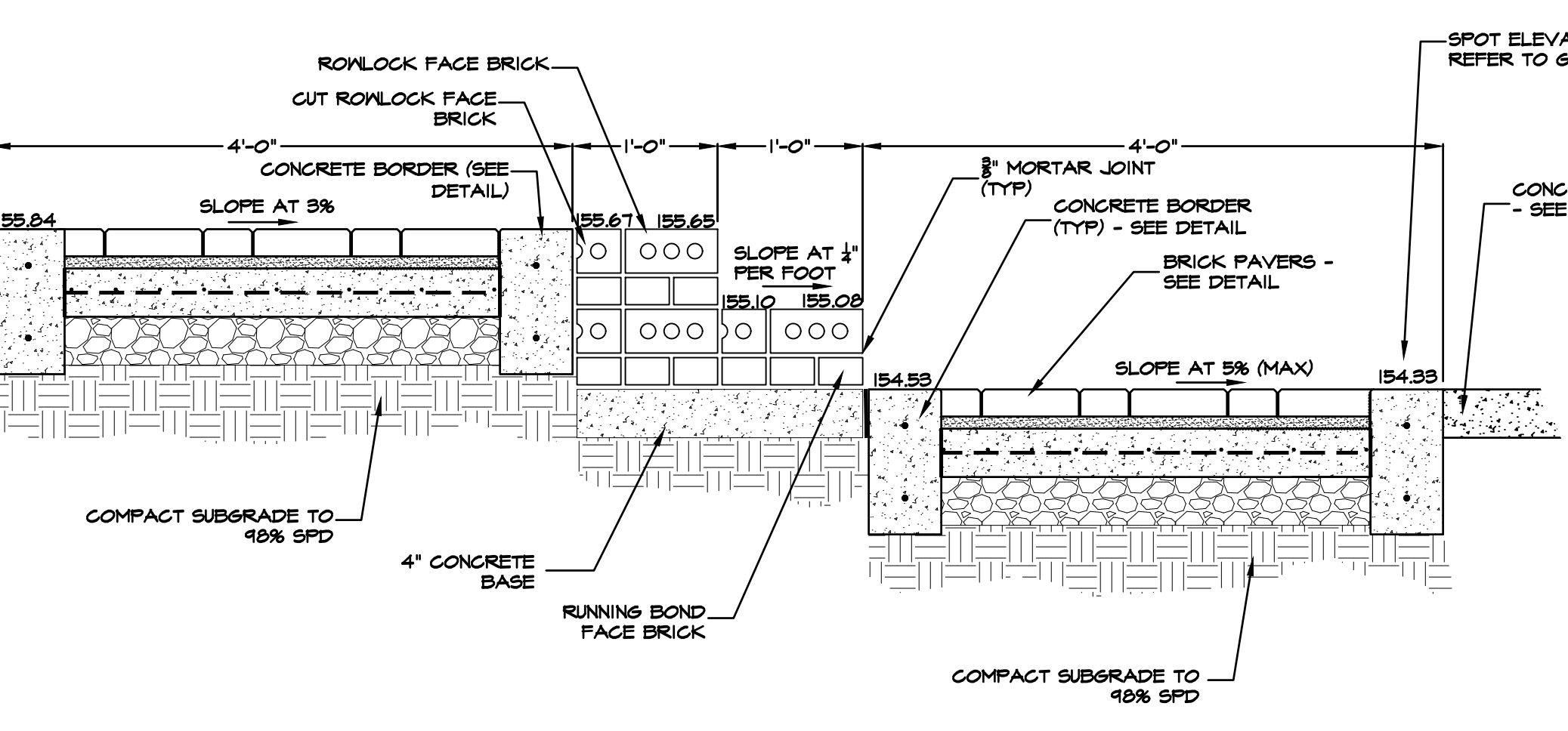

6 BRICK STEPS AND LANDINGS
L6.1 SECTION 1"=1'-0"

- BRICK NOTES**
- FACE BRICK SHALL BE MATSONTOWN CHOCOLATE WIRECUT MODULAR AS PROVIDED BY THE EXUM COMPANY (803-254-8493) OR APPROVED EQUAL.
 - MORTAR SHALL BE ARGOS KHAKI MASONRY CEMENT AS PROVIDED BY THE EXUM COMPANY (803-254-8493) OR APPROVED EQUAL. SUBMIT COLOR SAMPLE FOR APPROVAL PRIOR TO CONSTRUCTION.
 - SOLID BRICK HEADER SHALL BE MERIDIAN CHOCOLATE WIRECUT MODULAR AS PROVIDED BY THE EXUM COMPANY (803-254-8493) OR APPROVED EQUAL.
 - BRICK PAVERS SHALL BE PINE HALL RUMBLE COCOA 2 1/4" THICK X 4" X 8" PAVER AS PROVIDED BY THE EXUM COMPANY (803-254-8493) OR APPROVED EQUAL.
 - REFER TO GRADING AND DRAINAGE PLANS FOR REQUIRED MINIMUM AND MAXIMUM SLOPES OF WALKS AND RAMPS.
 - REFER TO STAKING PLAN FOR REQUIRED WIDTHS, LENGTHS AND DISTANCES OF WALKS AND RAMPS.
 - GRADED AGGREGATE BASE COURSE FOR BOTH VEHICULAR AND NON-VEHICULAR AREAS SHALL CONFORM TO SCDOT STANDARD SPECIFICATION SECTION 305. GABC BASE COURSE FOR BRICK PAVER AREAS SHALL ALSO COMPLY ASTM D2940 STANDARDS.
 - SETTING BED AND JOINT SAND SHALL BE CONCRETE SAND (NOT MASONRY SAND) COMPLIANT WITH ASTM C-99.
 - SUBGRADE FOR ALL NON-VEHICULAR AREAS SHALL BE COMPACTED WITH A VIBRATING PLATE COMPACTOR TO 98% SPD OR EQUIVALENT THROUGH FIELD TESTING. UNSUITABLE SOILS SHALL BE REMOVED AND REPLACED BY THE CONTRACTOR.
 - REFER TO CIVIL DRAWINGS FOR ADDITIONAL INFORMATION. DISCREPANCIES BETWEEN DRAWINGS SHALL BE BROUGHT TO THE ATTENTION OF THE LANDSCAPE ARCHITECT AND CIVIL ENGINEER BEFORE PROCEEDING WITH THE WORK.
 - PROVIDE 1/2" EXPANSION JOINT IN ALL ABOVE AND BELOW GRADE CONCRETE AT 30 FT. EACH WAY MAX. CAULK ALL EXPANSION JOINTS WITH SELF-LEVELING NON-SHRINKING CAULK MATCHING CONCRETE COLOR.
 - FILL CAVITIES IN WALLS AND COLUMNS WITH GROUT AS WORK IS COMPLETED IN LIFTS NOT EXCEEDING 12" IN HEIGHT. ALLOW EACH LIFT TO DRY COMPLETELY BEFORE INSTALLING NEXT LIFT.
 - COVER TOP OF BRICK WORK AT THE COMPLETION OF EACH DAY AND PRIOR TO WEATHER EVENTS TO PROHIBIT RAIN AND MOISTURE FROM FILLING WALL CAVITY DURING CONSTRUCTION OR CONTACTING GROUT FILL. ALLOW WALL TO DRY COMPLETELY BEFORE INSTALLING FLASHING.
 - ALL MORTAR JOINTS SHALL BE TOOLED CONCAVE JOINTS.
 - ALL WALLS AND COLUMNS TO BE BUILT PLUMB.
 - CLEAN BRICK AS WORK PROGRESSES. DO NOT ALLOW MORTAR TO DRY ON BRICK FACES INTENDED TO BE FINISHED FACES OF THE WORK. CLEAN ONLY AS DIRECTED BY THE BRICK AND MORTAR MANUFACTURERS.
 - REFER TO SPECIFICATIONS.

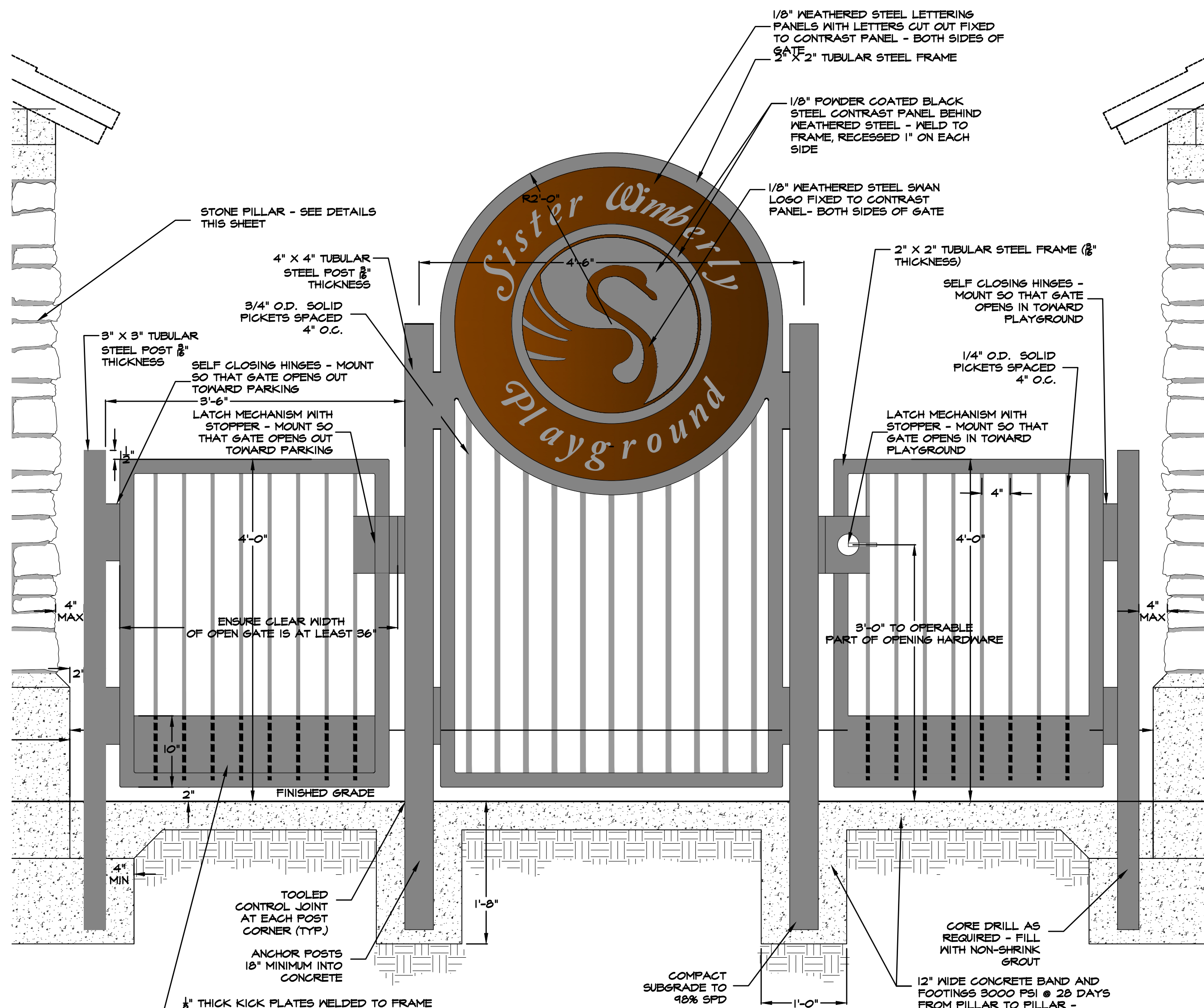

1 **STONE PILLAR ENTRY GATEWAY - FRONT VIEW**
L6.4 **ELEVATION 1"=1'-0"**

IRON FENCING AND GATE NOTES

1. ALL FENCING/GUARDRAIL COMPONENTS SHALL BE HOT ROLLED STRUCTURAL STEEL FINISHED WITH BLACK POWDER COATED. FINISHED WORK SHALL MATCH EXISTING FENCES AND GATES AT SWAN LAKE WITH REGARD TO CONSTRUCTION METHODS, MATERIALS AND FINISHES.
2. ALL MOUNTING BRACKETS SHALL BE 3/8" STEEL, POWDER COATED BLACK.
3. SUBMIT SAMPLES OF ALL COMPONENTS AND MOUNTING HARDWARE FOR APPROVAL PRIOR TO FABRICATION.
4. AVOID FIELD WELDING AND PAINTING. HOWEVER ANY FIELD WELDS SHALL BE GRIND SMOOTH AND PRIMED AND PAINTED TO MATCH WITH TWO COATS BLACK ALKYD ENAMEL TO MATCH FENCE PANELS.
5. ALL POSTS AND PICKETS SHALL STAND PLUMB.
6. FIELD VERIFY ALL DIMENSIONS OF WALKWAYS AND BRICK PIERS BEFORE FABRICATION AND INSTALLATION OF FENCES AND GATES.

GATE AND FENCE REPAIR NOTES

- EXISTING GATES AND FENCE PANELS ARE TO BE REMOVED PRIOR TO DEMOLITION AND RE-MOUNTED AT THE COMPLETION OF THE PROJECT. WHILE REMOVED, THE CONTRACTOR SHALL REPAIR AND REFINISH THE PIECES IN THE FOLLOWING MANNER:
1. STRAIGHTEN BENT PIECES.
 2. RE-WELD DISCONNECTED PIECES.
 3. CLEAN ALL DIRT, GREASE, DEBRIS AND RUST USING MECHANICAL AND CHEMICAL PROCESSES AS REQUIRED AND SAFE FOR THE MATERIAL.
 4. PREP FOR PAINTING ACCORDING TO APPLICABLE ASTM STANDARDS FOR THE MATERIAL.
 5. POWDERCOAT PAINT BLACK TO MATCH EXISTING SWAN LAKE GATES AND FENCES.
 6. REMOUNT GATES AT PROJECT COMPLETION UTILIZING EXISTING MOUNTING/HINGE HARDWARE WHICH HAS ALSO BEEN TREATED IN THE ABOVE MANNER.
 7. RE-ATTACH TO COLUMN BY WELDING MOUNTING HARDWARE TO STEEL TABS SET IN CONCRETE OF NEW COLUMNS.
 8. ADD 3/4" x 16" LENGTH BLACK STEEL L-SHAPED DROP PINS AND HOLDERS WELDED TO EACH VEHICULAR GATE LEAF. CORE DRILL 1" RECEIVER HOLE IN CONCRETE TO RECEIVE MINIMUM 6" LENGTH OF DROP PIN.

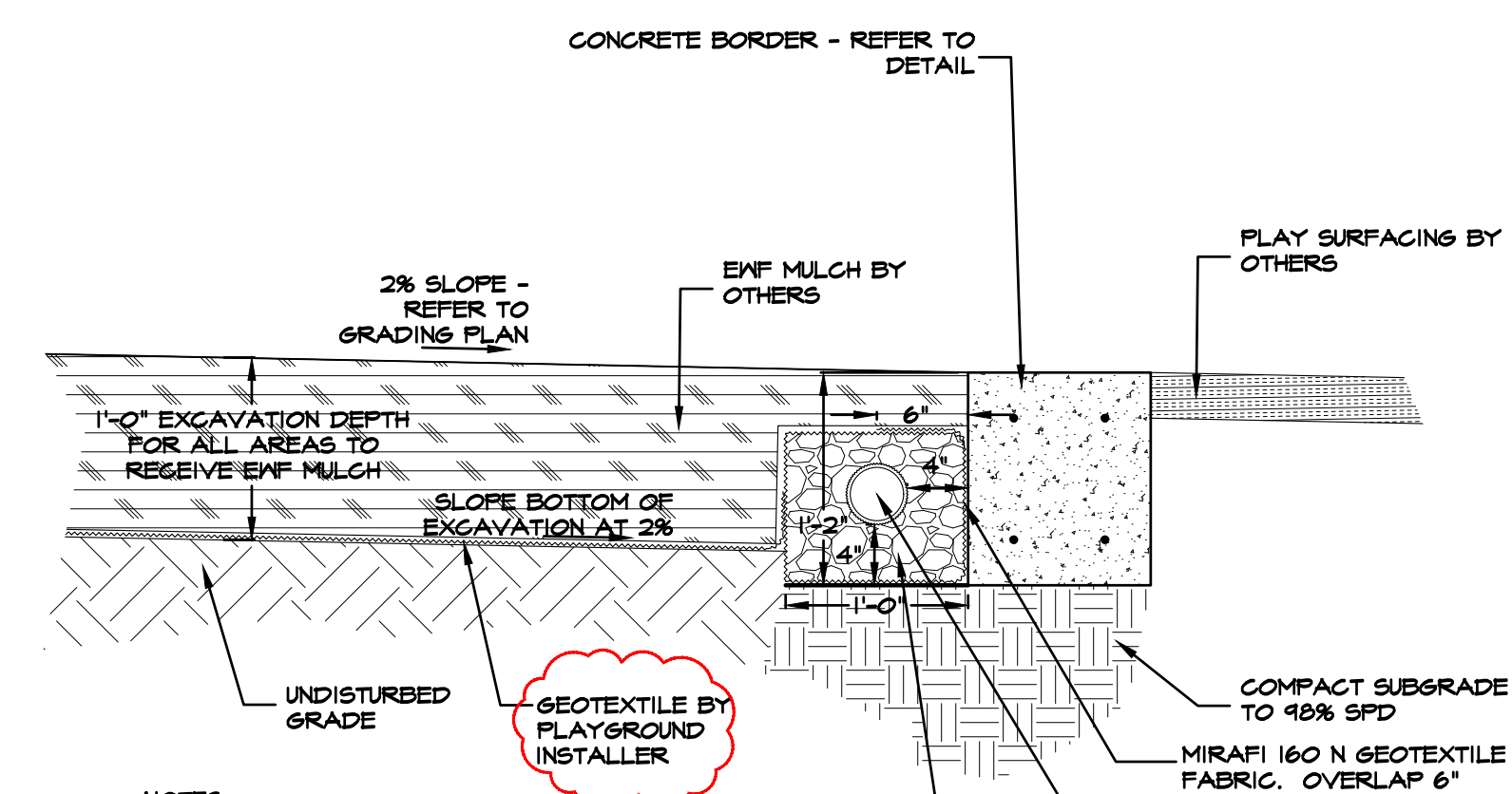

- NOTES:**
1. AFTER EXCAVATION, THE GENERAL CONTRACTOR SHALL COORDINATE WITH THE PLAY EQUIPMENT INSTALLER FOR REVIEW OF SITE PREPARATION AND SHALL MAKE ADJUSTMENTS BASED ON THAT REVIEW AS DIRECTED BY THE PLAY EQUIPMENT INSTALLER.
 2. INSTALL CENTURY 2420 ROOT BARRIER BY CENTURY PRODUCTS (114-652-1055) AT LOCATIONS SHOWN ON PLAN - TOP OF ROOT BARRIER SHALL BE 4" BELOW TOP OF MULCH AND SURROUNDING GRADE.

2 **SUBGRADE PREP FOR EWF**
L6.4 **ELEVATION 1"=1'-0"**

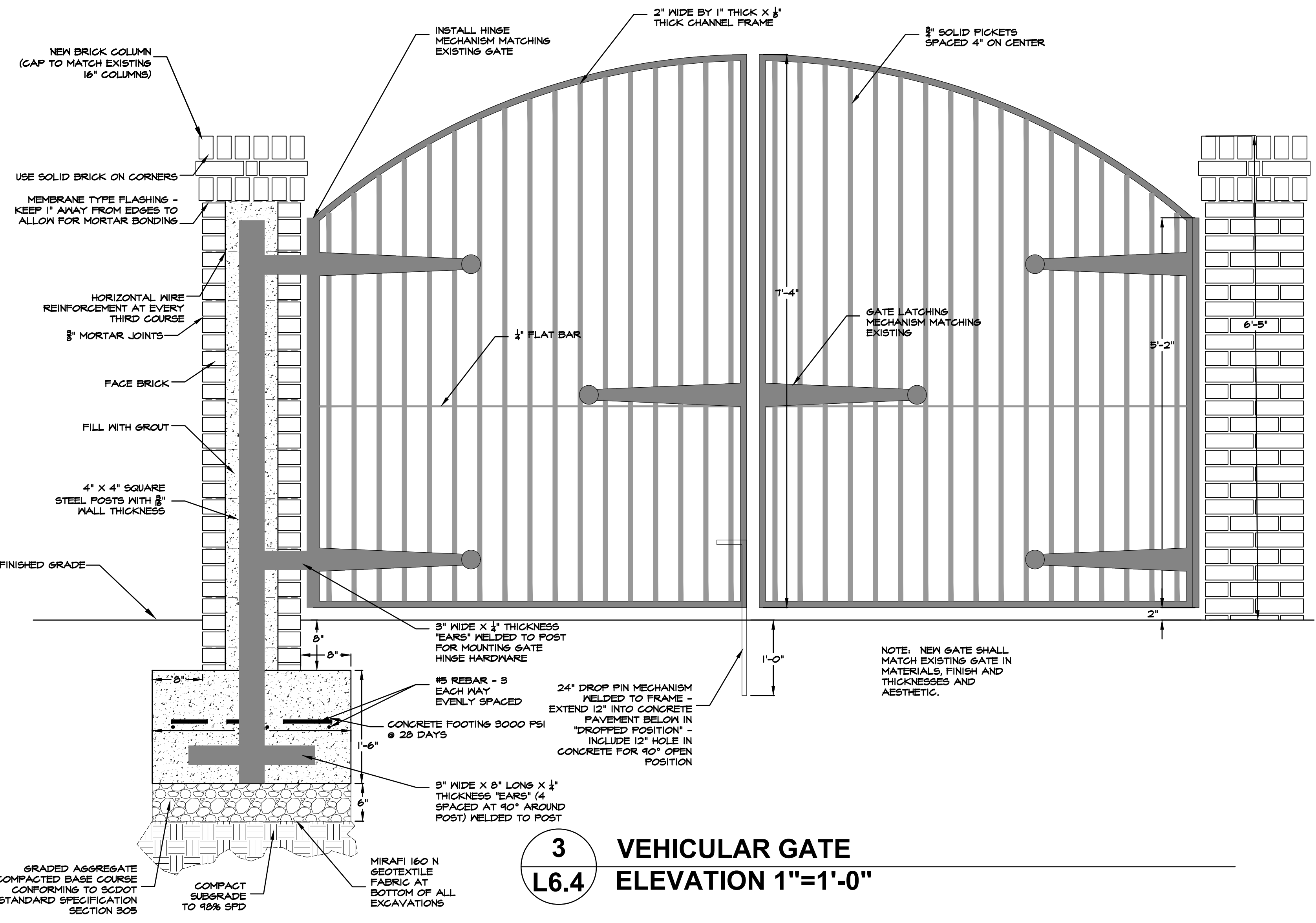

3 **VEHICULAR GATE**
L6.4 **ELEVATION 1"=1'-0"**

Sister Wimberly Playground

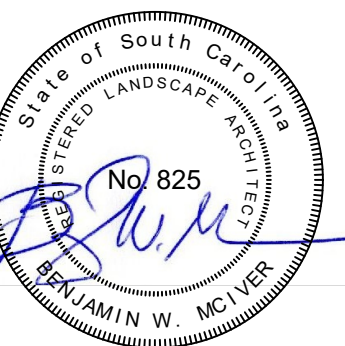
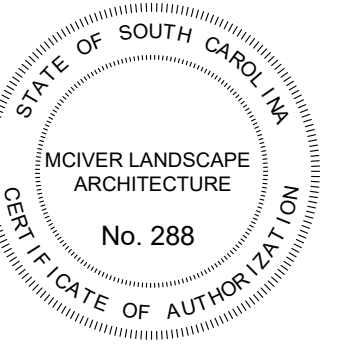

MCIVER LANDSCAPE ARCHITECTURE
 7 1/2 S. MAIN ST. SUMTER, SC 29150
 803-968-3992 INFO@MCIVERLA.COM

SEPT. 29, 2025

REV. DATE	NAME
10-30-25	BID ADDENDUM #2

SITE DETAILS

L6.4

PLANTING NOTES

- ALL PLANTING AREAS AND THOSE LABELED "MULCH" SHALL BE MULCHED WITH 3" OF TRIPLE SHREDDED HARDWOOD MULCH. REFER TO PLANTING SPECIFICATIONS FOR ADDITIONAL INFORMATION.
- ESTABLISH POSITIVE DRAINAGE AWAY FROM ALL STRUCTURES. ADD SCREENED ORGANIC TOPSOIL AS REQUIRED TO ACHIEVE POSITIVE DRAINAGE. INSTALL UNDERGROUND DRAINAGE AS NECESSARY. DO NOT DISCHARGE, REDIRECT, OR CONCENTRATE FLOW ONTO ADJACENT PROPERTIES.
- APPLY PRE-EMERGENT HERBICIDE TO ALL PLANTING AREAS AFTER PLANTING.
- CONTRACTOR TO APPLY POST EMERGENT HERBICIDE TO NEEDS IN ALL BEDS 3 WEEKS AFTER PLANTING IS FINALIZED.
- ALL LANDSCAPE AND IRRIGATION WORK SHALL HAVE A ONE YEAR WARRANTY AS EXPLAINED IN THE SPECIFICATIONS.
- ALL ELEMENTS SHALL BE CONSTRUCTED ACCORDING TO APPLICABLE BUILDING CODES AND ACCORDING TO MANUFACTURER'S SPECIFICATIONS.
- HAND DIG AND EXERCISE CAUTION WHEN PLANTING IN THE ROOT ZONE OF EXISTING TREES. REFER TO SPECIFICATIONS

FINE GRADING FOR LANDSCAPE AREAS NOTES:

- MAINTAIN POSITIVE DRAINAGE AWAY FROM ALL BUILDINGS AND WALKWAYS AND TOWARD DRAINAGE INLETS. ELIMINATE ALL LOW SPOTS EXCEPT THOSE AT DRAINAGE INLETS.
- FOR TURF AREAS, BRING FINISHED GRADE TO WITHIN 1" OF ADJACENT SIDEWALKS OR CURBS AFTER THE ADDITION OF SOIL AMENDMENTS. REFER TO SPECIFICATIONS FOR SOIL AMENDMENT REQUIREMENTS.
- FOR MULCHED AREAS (TREE, SHRUB AND GROUND COVER AREAS) WHICH ARE ADJACENT TO PAVED SURFACES, BRING FINISHED GRADE TO 3" BELOW THE ELEVATION OF THE PAVED SURFACE (AFTER THE ADDITION OF SOIL AMENDMENTS) AND TAPER TO THE GRADE ELEVATION SHOWN ON GRADING PLAN OVER A DISTANCE OF 24". REFER TO SPECIFICATIONS FOR SOIL AMENDMENT REQUIREMENTS.
- ADD SCREENED TOPSOIL WHERE REQUIRED TO BRING FINISHED GRADE TO FINAL LEVELS FOR PLANTING. REFER TO PLANTING SPECIFICATIONS FOR TOPSOIL REQUIREMENTS. REMOVE SOIL AS REQUIRED AND DISPOSE OF OFF SITE AFTER AMENDMENT TO MAINTAIN NECESSARY GRADES.

IRRIGATION NOTES

- REFER TO SLEEVING PLAN FOR LOCATIONS OF 4" PVC SLEEVES.
- MAINTAIN IRRIGATION SERVICE TO AREAS ADJACENT TO, BUT OUTSIDE OF, THE PROJECT AREA DURING AND AFTER CONSTRUCTION BY ADJUSTING THE EXISTING IRRIGATION SYSTEM AS REQUIRED TO KEEP THE SYSTEM FUNCTIONAL IN THOSE AREAS. PRIOR TO PROCEEDING WITH ANY SITE DEMOLITION, THE CONTRACTOR SHALL OPERATE AND ASSESS THE EXISTING IRRIGATION SYSTEM AND SUBMIT IN WRITING THE PROPOSED ADJUSTMENTS TO THE LANDSCAPE ARCHITECT AND CITY OF SUMTER PROJECT MANAGER FOR APPROVAL. PRESERVE AND PROTECT EXISTING MAIN LINE AND VALVES WITHIN THE PROJECT AREA THAT SERVICE AREAS ADJACENT TO THE PROJECT SITE. REPAIR ANY EXISTING MAIN LINE OR VALVES DAMAGED DURING THE INSTALLATION PROCESS. RELOCATE EXISTING MAIN LINE OR VALVES SERVING AREAS ADJACENT TO THE PROJECT SITE WHICH ARE IN CONFLICT WITH NEW CONSTRUCTION. CAP OR REMOVE ALL ABANDONED LINES.
- ALL NEW PLANTINGS AND SOD SHALL BE IRRIGATED WITH AN UNDERGROUND IRRIGATION SYSTEM COMPLIANT WITH THE IRRIGATION PERFORMANCE SPECIFICATIONS. THE CONTRACTOR SHALL DESIGN AND SUBMIT THE IRRIGATION PLAN FOR APPROVAL BY THE LANDSCAPE ARCHITECT AND CITY OF SUMTER PROJECT MANAGER PRIOR TO INSTALLATION.
- COORDINATE IRRIGATION WORK WITH GENERAL CONTRACTOR AND WITH CITY OF SUMTER MAINTENANCE STAFF.
- UTILIZE EXISTING CONTROLLER. ADD EXPANSION MODULE AS REQUIRED.
- FLAG ANY LATERAL LINES THAT ARE CUT DURING THE PLANTING OR INSTALLATION PROCESS AND MARK LOCATIONS AND SIZE OF LINE ON AS-BUILT-IRRIGATION DRAWING. PROVIDE TO OWNER.
- WITHIN EXISTING TREE AREA, TAKE CARE TO PROTECT TREE ROOTS. MINIMIZE MECHANICAL TRENCHING, HAND DIG AS REQUIRED TO PROTECT TREE ROOTS. ESTABLISH LATERAL LINE LAYOUT THAT MINIMIZES DAMAGE TO EXISTING TREE ROOTS. TRENCHING LOCATIONS WITHIN DRIP LINE OF EXISTING TREES MUST BE APPROVED BY LANDSCAPE ARCHITECT. TRENCH ALONG EXISTING SIDEWALK EDGES AND WITHIN FILL DIRT AREAS WHEREVER POSSIBLE.

PLANT LIST

Plan Label	Common Name	Botanical Name	Cultivar	Caliper	Cont/ Ball Size	Min. Ht	Min. Sprd.	Num Canes/ Trunks 3-5	Spacing on center /ft	Comments
AMEL	AUTUMN BRILLIANCE SERVICEBERRY	AMELANCHIER X GRANDIFLORA	AUTUMN BRILLIANCE			7'-8"	6'			MULTI-STEMMED SPECIMENS
CERC	OKLAHOMA REDBUD	CERCIS TEXENSIS	OKLAHOMA	2"	28"	10'-12"	6'-8"	1		MATCHING SPECIMENS, STRAIGHT TRUNK, FULL CROWN
CLAD	YELLOWWOOD	CLADRASTIS KENTUCKEA		1"	24"	8'-10"	6'-6"	1		MATCHING SPECIMENS, STRAIGHT TRUNK, FULL CROWN
CORN	KOLSA DOGWOOD	CORNUS KOLSA			28"	10'-12"	6'-8"	3-4		MATCHING MULTI-STEMMED SPECIMENS
DRYO	AUTUMN FERN	DRYOPTERIS ERYTHROSORA		1 GAL	18"	18"	5-7	30"		FULL PLANT IN STAGGERED ROWS
ECHI	PURPLE CONEFLOWER	ECHINACEA PURPUREA	MAGNUS	1 GAL	12"	12"	FULL	18"		FULL
GINK	PRINCETON SENTRY GINKGO	GINKGO BILOBA	PRINCETON SENTRY	3"	32" BALL	12'-14"	6'-8"	1		SPECIMEN, SINGLE LEADER, STRAIGHT TRUNK, FULL CROWN
HYDR	OAK LEAF HYDRANGEA	HYDRANGEA QUERCIFOLIA	SNOW QUEEN	3 GAL	18"	18"	5-7	4'		FULL
ILEX EP	EAST PALATKA HOLLY	ILEX X ATTENUATA	EAST PALATKA	2"	24" BALL	10'-12"	6'-7"	1		MATCHING SPECIMENS, STRAIGHT TRUNK, STANDARDS WITH CENTRAL LEADER, FULL CROWN
ILEX G	NORDIC INKBERRY HOLLY	ILEX GLABRA	CHAMZIN	3 GAL	18"	18"	5-7	4'		FULL
ILEX V	WINTERBERRY HOLLY	ILEX VERTICILLATA	BERRY HEAVY	7 GAL	36"	36"	5-7	6'		FULL
ILEX VMP	MALE WINTERBERRY HOLLY	ILEX VERTICILLATA	MR. POPPINS	3 GAL	18"	18"	5-7	3'		FULL
ILLI	SMALL ANISE TREE	ILICUM PARVIFLORUM			7 GAL	36"	24"	5-7	5'	FULL
ITEA	VIRGINIA SWEETSPICE	ITEA VIRGINICA	HENRY'S GARNET	3 GAL	18"	18"	5-7	4'		FULL
JUN GO	GREY OWL JUNIPER	JUNIPERUS VIRGINIANA	GREY OWL	7 GAL	36"	36"	5-7	4'		FULL
LORO	EMERALD SNOW LOROPETALUM	LOROPETALUM CHINENSE	EMERALD SNOW	3 GAL	18"	18"	5-7	3'		FULL PLANT IN STAGGERED ROWS
MAGN	LITTLE GEM MAGNOLIA	MAGNOLIA GRANDIFLORA	LITTLE GEM	2"	24"	6'	4'	1		MATCHING SPECIMENS, FULL TO GROUND
MAHO	SOFT CARESS MAHONIA	MAHONIA EURYBRACTEATA	SOFT CARESS	3 GAL	18"	18"	5-7	3'		FULL
MJHL	WHITE MIMLY GRASS	MULLENBERGIA CAPILLARIS	WHITE CLOUD	3 GAL	18"	12"	FULL	3'		FULL
NYSS	BLACK GLIM	NYSSA SYLVATICA		3"	32"	14'	6'	1		MATCHING SPECIMENS, SINGLE LEADER STRAIGHT TRUNK, FULL CROWN
PODO	PRINGLES YEW	PODOCARPUS MACROPHYLLUS	PRINGLES DWARF	3 GAL	18"	12"	5-7	3'		FULL
QUER	NUTTALL OAK	QUERCUS NUTTALLI		3"	32"	14'	6'	1		MATCHING SPECIMENS, STRAIGHT TRUNK AND CENTRAL LEADER, FULL CROWN
RHOD	GEORGE TABER AZALEA	RHOODODENDRON X GEORGE TABER	GEORGE TABER	3 GAL	24"	24"	5-7	6'		FULL
RHUS	DWARF FRAGRANT SUMAC	RHUS AROMATICA	GRO-L-OW	3 GAL	18"	18"	5-7	4'		FULL
RUIDB	BLACK-EYED SUSAN	RUIDECKIA FULGIDA VAR. SULLIVANTII	GOLDSTURM	1 GAL	12"	12"	FULL	18"		FULL
SERE	SAW PALMETTO	SERENOA REPENS		3 GAL	24"	24"	3-5	4'		FULL
VIBU ML	MOONLIT LACE VIBURNUM	VIBURNUM DAVIDI X TINUS	MOONLIT LACE	3 GAL	18"	18"	5-7	3'		FULL
VIBU MS	MRS. SCHILLERS DELIGHT VIBURNUM	VIBURNUM OBOVATUM	MRS. SCHILLERS DELIGHT	3 GAL	12"	18"	5-7	3'		FULL PLANT IN STAGGERED ROWS
SOD	ZEON ZOYSIA SOD	ZOYSIA JAPONICA	SCHILLERS DELIGHT ZEON							WELL ROOTED - REFER TO SPECIFICATIONS

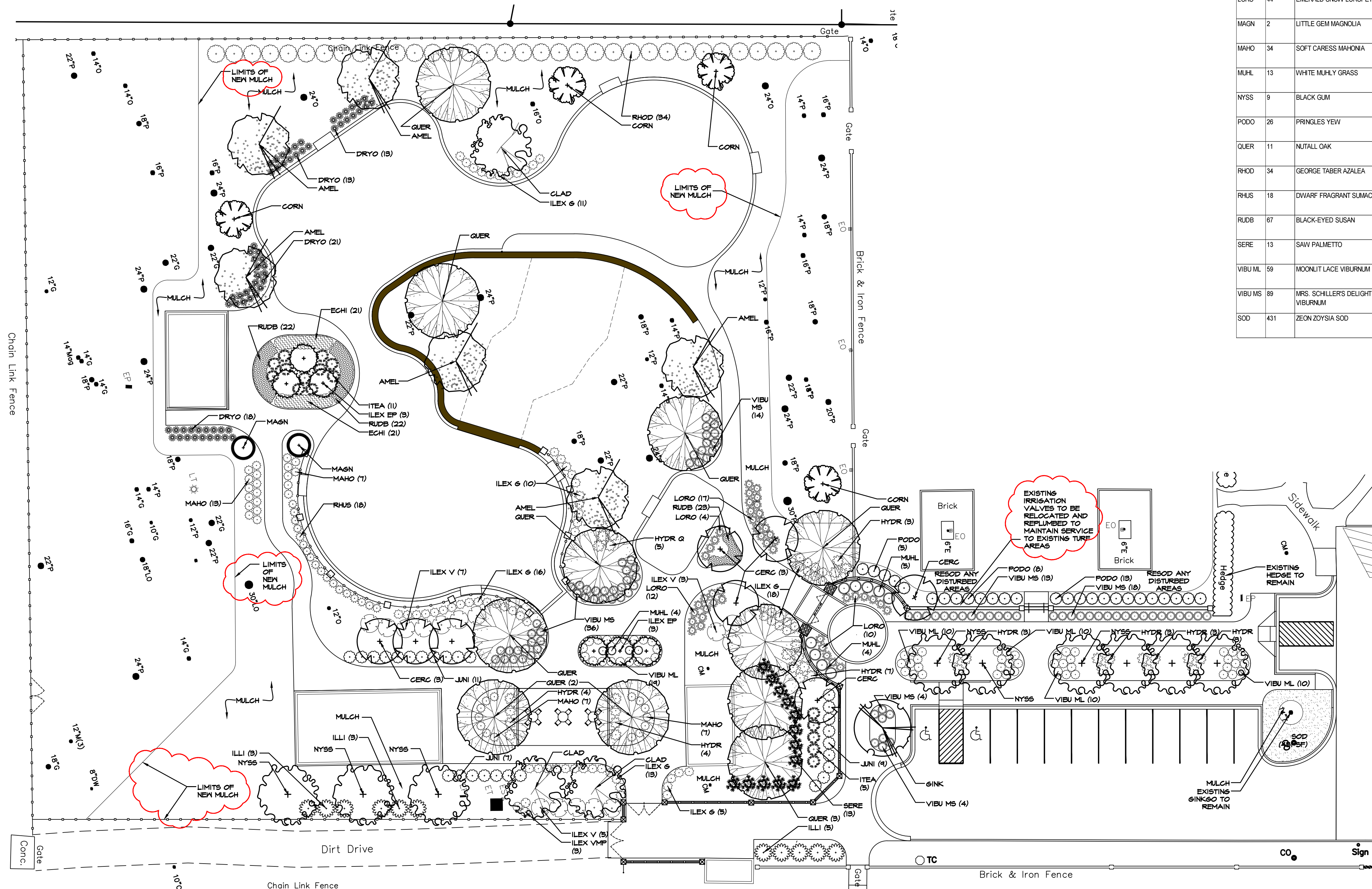

GENERAL NOTES

- CONTRACTOR SHALL OBTAIN ALL NECESSARY PERMITS.
- THE CONTRACTOR IS HEREBY INFORMED OF THE EXISTENCE OF UNDERGROUND UTILITIES. THE CONTRACTOR SHALL BE RESPONSIBLE FOR THE EXACT LOCATION OF ALL UTILITIES, AND ANY AND ALL DAMAGE RESULTING FROM THE FAILURE TO DO SO. CONTACT PALMETTO UTILITY PROTECTION SERVICE AT 1-800-721-7877 AT LEAST 72 HOURS PRIOR TO COMMENCING CONSTRUCTION. UTILITY LOCATION INFORMATION MAY ALSO BE OBTAINED FROM LOCAL MUNICIPALITIES.
- CONTRACTOR SHALL INFORM LANDSCAPE ARCHITECT IF PROPOSED DESIGN IS IN CONFLICT WITH EXISTING OR PROPOSED UTILITIES. CONTRACTOR SHALL COORDINATE WITH LANDSCAPE ARCHITECT PRIOR TO CONSTRUCTION TO ADJUST PROPOSED DESIGN OR UTILITIES AS NECESSARY TO RESOLVE CONFLICTS.
- ACTUAL EXISTING CONDITIONS MAY REQUIRE ADJUSTMENT OF THESE PLANS TO FIT THE SITE. STAKE-OUT/LAYOUT OF DESIGN BY THE CONTRACTOR AND ADJUSTMENT/APPROVAL BY THE LANDSCAPE ARCHITECT IS REQUIRED PRIOR TO CONSTRUCTION.
- BASE PLAN DATA DERIVED FROM SITE SURVEY AS PREPARED BY LINDLER SURVEYING FOR THE CITY OF SUMTER, JANUARY 15, 2024 AND REVISED AUGUST 15, 2024.
- ALL ELEMENTS SHALL BE CONSTRUCTED ACCORDING TO APPLICABLE BUILDING CODES AND ACCORDING TO MANUFACTURER'S SPECIFICATIONS.
- REFER TO SPECIFICATIONS FOR ADDITIONAL INFORMATION AND REQUIREMENTS.



822 West Liberty Street
Sumter, SC

Sister
Wimberly
Playground

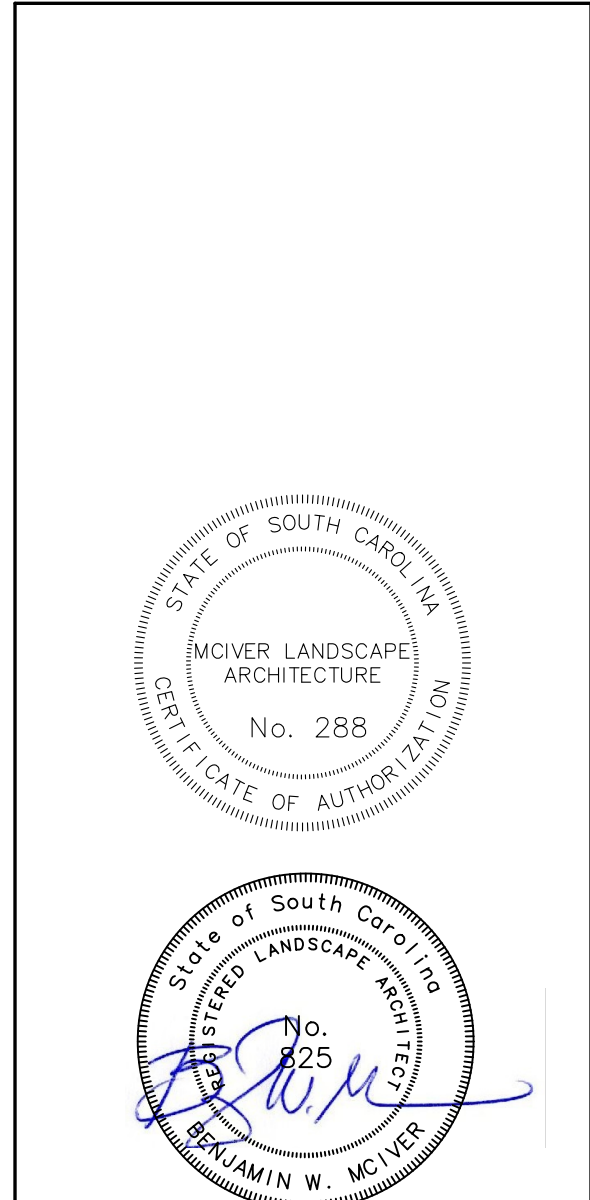

SEPT. 29, 2025

REV. DATE	NAME
10-30-25	BID ADDENDUM #2

PLANTING PLAN

L7.1

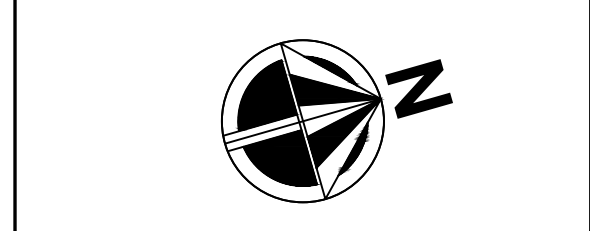

0' 10' 20'
SCALE 1" = 20'-0"