

City of Sumter

Hazard Mitigation Grants

Joint Federal, State, Local Public Notice



The Federal Emergency Management Agency (FEMA) and South Carolina Emergency Management Division (SCEMD) have received an application for Federal grant funding through the Hazard Mitigation Grant Program (HMGP). Funding for this grant was made available after the 4241 Presidential declaration was made regarding the flood of October 2015. This historic flooding event affected the state of South Carolina from October 1 to October 5. A stalled front offshore combined with deep tropical moisture streaming northwest into the area, ahead of a strong upper-level, low-pressure system to the west and Hurricane Joaquin to the east. This storm caused severe flooding to the City of Sumter area.

Funding for the proposed project listed below will be conditional upon compliance with all applicable federal, tribal, state, and local laws, regulations, floodplain standards, permit requirements and conditions. Under the National Environmental Policy Act (NEPA), federal actions must be reviewed and evaluated for feasible alternatives and for social, economic, historic, environmental, legal, and safety considerations. Under Executive Order (EO) 11988 and EO 11990 FEMA is required to consider alternatives to and to provide public notice of any proposed actions in or affecting floodplains and wetlands. EO 12898 also requires FEMA to provide the opportunity for public participation in the planning process and to consider potential impacts to minority or low-income populations.

Applicant: City of Sumter

Project Title: Croswell Drainage Improvements

Project Location: Croswell Neighborhood — This project will include the upgrading and installation of storm drainage improvements along Bagnal Drive, D’Ancona Drive, Loring Drive, Robney Drive and Dogwood Drive. These improvements include the upgrading of the outfall ditch and pipe system draining to Turkey Creek along D’Arcona Drive. There are no anticipated wetland impacts associated with this project.

Project Description: As the first phase to improve drainage and relieve flooding within the Crosswell neighborhood, the City intends to complete the following activities along Bagnal, the eastern side of Dogwood, eastern side of Robney, eastern side of Loring and portions of E Wen-Le Court, and all of D’Ancona Drive from Bagnal to the discharge point to Turkey Creek. These activities will improve conveyance and reduce localized flooding throughout the eastern side of the neighborhood. The second phase of the project will be to address the drainage system to the west of Phase I. This project has been broken into these two phases based on the drainage areas, frequency of localized flooding and cost considerations associated with each phase of the project. The following represents the scope of Phase I of the project under the scope of FEMA HMGP funding.

- Add/replace additional catch basins along Robney Drive, and Loring Drive. These catch basins will intercept overland flow from surrounding areas along secondary lines and direct water toward main storm drain lines along Bagnal Drive.
- Add/replace catch basins along Bagnal Drive, and D’Ancona Drive. These catch basins will intercept overland flow from surrounding areas along the main storm drain line.
- Rehabilitate existing 48” RCP main storm drain line along the east side of Bagnal Drive. A survey would need to be completed to collect invert elevations at each catch basin along the 48” RCP. This survey would determine if sections of the drain line are set at reverse grade thus impeding flow. Sections of the drain line at reverse grade would be replaced to ensure positive flow in the downstream direction. Catch basins along this drain line may be rehabbed or replaced depending on condition.
- Replace and regrade existing main storm drain lines along south side of D’Ancona Drive. Replace the existing 60” RCP and 48” elliptical pipes with 60” RCP.
- Replace, upsize, and regrade existing main storm drain lines along the north side of D’Ancona Drive. Replace the existing 24” RCP with 48” RCP.
- Add an additional main storm drain line along the west side of Bagnal Drive. Replace the existing storm drain lines with 42” RCP from intersection of Bagnal Drive and D’Ancona Drive to north of Dogwood Drive.
- Add two storm drainage ponds south of Loring Drive. The ponds would be sized approximately 1 acre and 0.5 acres and would receive stormwater runoff from Loring Drive, Cecil Street, and E. Wen-Le Court. The ponds would temporarily detain water and outfall to Turkey Creek near D’Ancona Drive.
- Add/replace approximately 12 catch basins along Loring Drive and Robney Drive to collect overland flow from surrounding areas and direct water toward the stormwater ponds south of Loring Drive.
- Regrade and rehabilitate existing ditches along D’ancona Drive and Bagnal Drive.

The above recommendations would result in significant improvements to the storm drainage within Crosswell neighborhood. Based on modeling efforts, these improvements are anticipated to effectively drain the 2-year storm. The 10-year storm would result in minor local flooding in low lying areas such as Loring Street. Pooling water would not be anticipated to remain for more than 30 minutes. The 25-year storm would result in similar conditions to the 10-year storm event and result in pooling water for periods less than 1 hour. These conditions would represent significant drainage improvements in the Crosswell neighborhood.

Alternatives Considered: The feasibility assessment of this project included an analysis of the downstream receiving waters and adjacent neighborhoods. The potential to modify Turkey Creek is limited in that it is a regulated conveyance by the USACE. Extension or modification of this drainage way is limited by those regulations as well as private property. Thus, extension of the canal was deemed not feasible. Adjacent neighborhoods have limited capacity to receive additional flow from this neighborhood as well. This portion of the City of Sumter is very flat, and the length of system to drain to ditch systems in adjacent neighborhoods is limited by topography. There is an existing culvert down Bagnal Drive that could be utilized and can handle additional flow. One alternative considered was to run catch basins and smaller pipes through the neighborhood to that main system on Bagnal. However, hydraulically that’s not feasible from a capacity issue.

The only reasonable alternative would involve the installation of a stormwater pump station at Bagnal and Loring Drive. This could improve drainage by using smaller pipes throughout the neighborhood. However, the overall cost reduction in the conveyance system would be offset by the cost of the pump station and wet well.

Comments Period: The City of Sumter will be responsible for facilitating and monitoring the proposed project. Interested persons may submit comments, obtain more detailed information about the proposed action, or request a copy of the findings by contacting:

City of Sumter

Attn: Teige Elliott

PO Box 1449

Sumter, SC 29151

Email: telliott@sumtersc.gov

Telephone: (803) 436-2644

Posted: November 5, 2020

Comments and request for information are due within 15 days of this notice.

Filename: C:\060591852_SUMTER CROSSWELL STORMWATER\2019-08-01 SUMTER CROSSWELL PHASE DIAGRAM.DWG

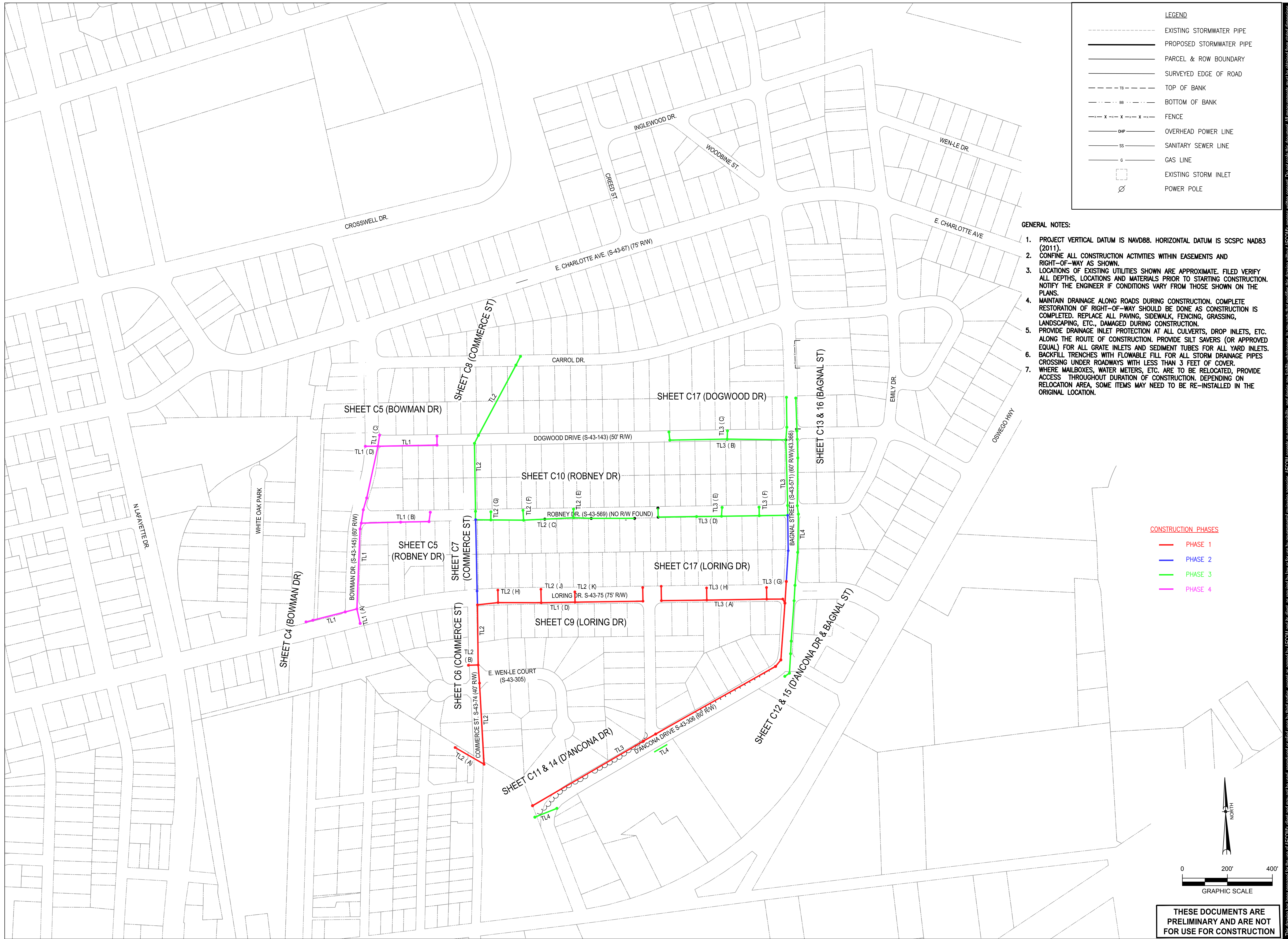

LEGEND

- EXISTING STORMWATER PIPE
- PROPOSED STORMWATER PIPE
- PARCEL & ROW BOUNDARY
- SURVEYED EDGE OF ROAD
- TOP OF BANK
- BOTTOM OF BANK
- x-x-x-x-x-x-x-x-x-x- FENCE
- OHP --- OVERHEAD POWER LINE
- SS --- SANITARY SEWER LINE
- G --- GAS LINE
- EXISTING STORM INLET
- POWER POLE

- GENERAL NOTES:**
- PROJECT VERTICAL DATUM IS NAVD88. HORIZONTAL DATUM IS SCSPC NAD83 (2011).
 - CONFINE ALL CONSTRUCTION ACTIVITIES WITHIN EASEMENTS AND RIGHT-OF-WAY AS SHOWN.
 - LOCATIONS OF EXISTING UTILITIES SHOWN ARE APPROXIMATE. FILED VERIFY ALL DEPTHS, LOCATIONS AND MATERIALS PRIOR TO STARTING CONSTRUCTION. NOTIFY THE ENGINEER IF CONDITIONS VARY FROM THOSE SHOWN ON THE PLANS.
 - MAINTAIN DRAINAGE ALONG ROADS DURING CONSTRUCTION. COMPLETE RESTORATION OF RIGHT-OF-WAY SHOULD BE DONE AS CONSTRUCTION IS COMPLETED. REPLACE ALL PAVING, SIDEWALK, FENCING, GRASSING, LANDSCAPING, ETC. DAMAGED DURING CONSTRUCTION.
 - PROVIDE DRAINAGE INLET PROTECTION AT ALL CULVERTS, DROP INLETS, ETC. ALONG THE ROUTE OF CONSTRUCTION. PROVIDE SILT SAVERS (OR APPROVED EQUAL) FOR ALL GRATE INLETS AND SEDIMENT TUBES FOR ALL YARD INLETS. BACKFILL TRENCHES WITH FLOWABLE FILL FOR ALL STORM DRAINAGE PIPES CROSSING UNDER ROADWAYS WITH LESS THAN 3 FEET OF COVER.
 - WHERE MAILBOXES, WATER METERS, ETC. ARE TO BE RELOCATED, PROVIDE ACCESS THROUGHOUT DURATION OF CONSTRUCTION. DEPENDING ON RELOCATION AREA, SOME ITEMS MAY NEED TO BE RE-INSTALLED IN THE ORIGINAL LOCATION.

CONSTRUCTION PHASES

- PHASE 1
- PHASE 2
- PHASE 3
- PHASE 4

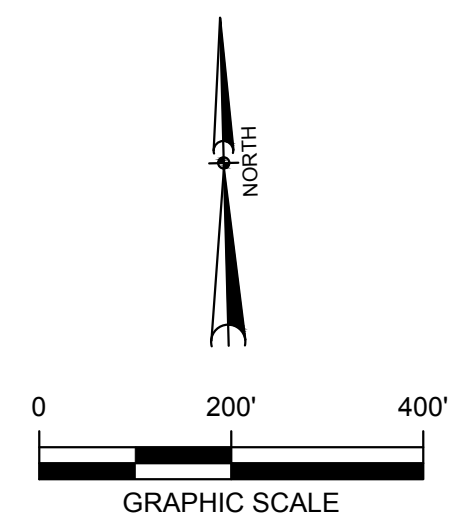

THESE DOCUMENTS ARE PRELIMINARY AND ARE NOT FOR USE FOR CONSTRUCTION



PROJECT
 Crosswell Neighborhood Stormwater Improvements

CLIENT
 City of Sumter
 303 East Liberty Street
 Sumter, South Carolina, 29150

CONSULTANT
 AECOM
 101 Research Drive
 Columbia, South Carolina, 29203
 803.254.4400 tel 803.771.6675 fax
 www.aecom.com

REGISTRATION

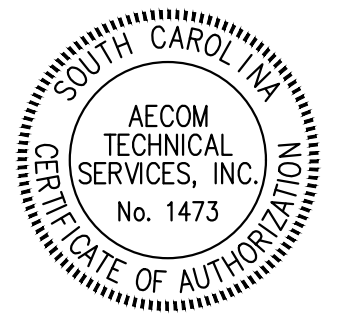

ISSUE/REVISION

I/R	DATE	DESCRIPTION

KEY PLAN

PROJECT NUMBER
 60591852

SHEET TITLE
 OVERALL STORMWATER IMPROVEMENT PLAN

SHEET NUMBER
 C3

This drawing has been prepared for the use of AECOM's client and may not be used, reproduced or relied upon by third parties, except as agreed by AECOM and its client, as required by law or for use by governmental reviewing agencies. AECOM accepts no responsibility, and denies any liability whatsoever, to any party that modifies this drawing without AECOM's express written consent. Do not scale this document. All measurements must be obtained from staked dimensions.